

Where Creativity Meets Color!

SUZI

STORAGE SIDEKICK

OWNER'S MANUAL

Assembly Instructions

Model Numbers:

800	Oak
801	White
802	Cherry
803	Black
804	Pistachio Green
809	Blue

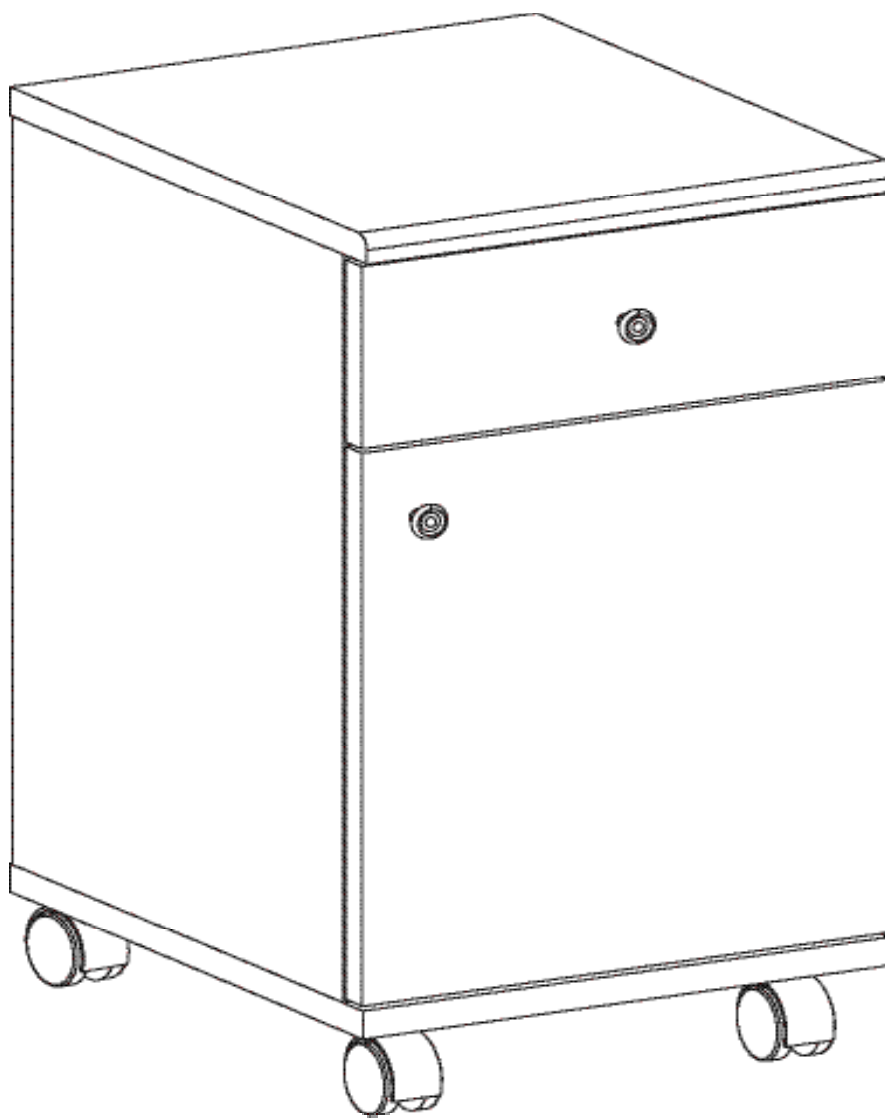

IMPORTANT: Please read these instructions before assembling!



LIMITED WARRANTY

Arrow™ Sewing Furniture 10-Year Warranty

WHAT THIS WARRANTY COVERS: Arrow Companies, LLC (Arrow) provides limited warranty coverage to the original purchaser of this product against defects in materials or workmanship of Arrow furniture components for a period of ten years from the date of purchase. As used in this Warranty, "defect" means imperfections in components which substantially impair the utility of the product. This Warranty gives you specific legal rights, and you may also have other rights which vary from state to state.

HOW TO GET SERVICE: Simply contact Arrow at 1-800-533-7347 or CS@ArrowCabinets.com. When you request warranty service, you must also present proof of purchase documentation, which includes the date of purchase (detailed receipt), and photos of the product. Arrow will replace any defective part (at its sole option), excluding labor. Replacement parts will be warranted for only the remaining period of the original Warranty.

Replacement parts will be shipped freight prepaid on any initial warranty claim during first year of Warranty only. Warranty applies only to defects confirmed by Arrow Companies, LLC and will be replaced or repaired at Arrow's option. In the event parts are no longer available for a warranty claim, customer may receive brand new cabinet at a price equal to 60% off the MSRP of a current comparable model.

WHAT'S NOT COVERED: There is no warranty coverage for defects or conditions that result from the failure to follow product assembly instructions, information or warnings, misuse or abuse, intentional damage, fire, flood, alteration or modification of the product, or use of the product in a manner inconsistent with its intended use, nor any condition resulting from incorrect or inadequate maintenance, cleaning, or care, or neglect, cuts or scratches. Caster damage as a result of moving furniture fully loaded or with locked casters. Damage resulting from electrical surge or lightning. Use in commercial or education environments. Arrow Sewing Furniture is designed for residential use only.

ARROW SHALL HAVE NO LIABILITY for ANY INCIDENTAL OR CONSEQUENTIAL DAMAGES OF ANY KIND and all such damages are EXCLUDED FROM THIS WARRANTY, such as loss of use, disassembly, transportation, labor or damage to property on or near the product. Some states do not allow the exclusion or limitation of incidental or consequential damages, so the above limitation or exclusion may not apply to you. The Warranty cannot be transferred to subsequent owners or users of the product, and it shall be immediately void in the event the product is resold, transferred, leased or rented to any third party or person other than the original purchaser.

ADDITIONAL LIMITATIONS:

THERE ARE NO OTHER WARRANTIES APPLICABLE TO THIS PRODUCT. Under the laws of certain states, there may be no implied warranties from Arrow and all implied warranties, INCLUDING ANY IMPLIED WARRANTY OF MERCHANTABILITY OR FITNESS FOR A PARTICULAR PURPOSE are disclaimed where allowed by law. TO THE EXTENT ANY IMPLIED WARRANTIES ARE APPLICABLE, ANY IMPLIED WARRANTIES, INCLUDING ANY IMPLIED WARRANTY OF MERCHANTABILITY OR FITNESS FOR A PARTICULAR PURPOSE, ARE LIMITED IN DURATION TO THE DURATION OF THIS EXPRESS WARRANTY or the minimum period allowed by law, whichever is shorter. Some states do not allow limitations on how long an implied Warranty lasts, so the above limitation may not apply to you. This limited warranty gives you specific legal rights. This limited warranty does not, in any way, affect the rights given to you by law.

REGISTER YOUR PRODUCT: Original purchaser should register the purchase online at www.ArrowCabinets.com/warranty.

Notice to Customer:

Before beginning assembly, remove all parts from the carton. Please review the illustrations below to determine that all parts are Included.

For assembly or operating assistance, or to report any missing or damaged parts, you may call or write to:

cs@arrowcabinets.com

1-800-533-7347

Arrow Cabinets

P.O. Box 307, Delavan, WI 53115

TO ORDER REPLACEMENT PARTS CALL

1-800-533-7347

NOTE: To assure proper handling of replacement parts please include the following information:

- **Model Number of Unit -** 800 (Oak)
801 (White)
802 (Cherry)
803 (Black)
804 (Green)
809 (Blue)
- **Production ID Number**
- **Number of Part Required**
- **Your Name, Address, and Phone Number**

Wooden Materials

Parts are labeled with capital letters. To reference letters, turn to the Wood Parts List in the back of your manual.

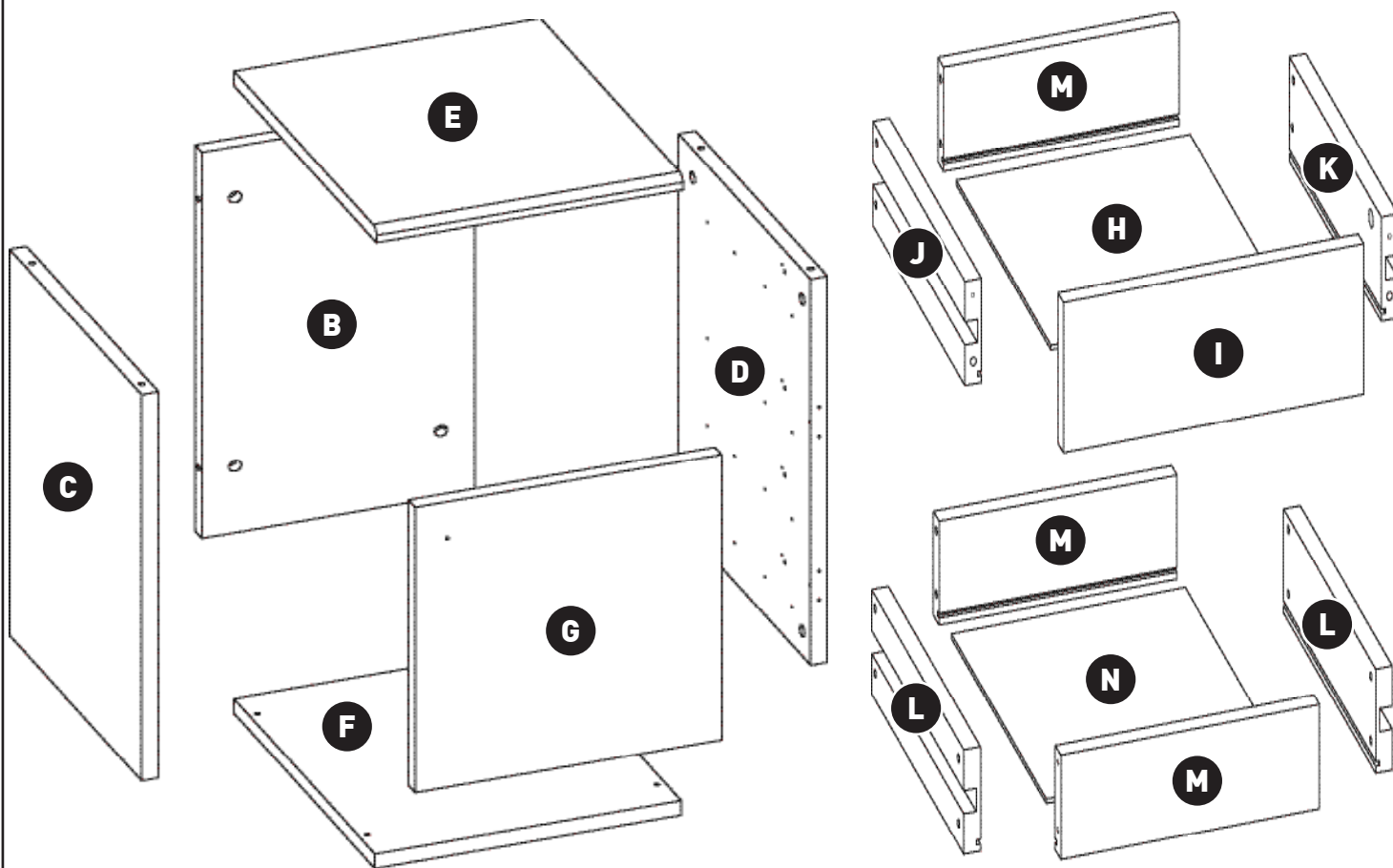

- | | | | |
|---------------------|---------------------------|-------------------------------------|---------------------------|
| B Back | F Bottom | K Drawer Side Top Side Right | N Drawer Bottom x3 |
| C Left Side | G Door | L Drawer Side x6 | |
| D Right Side | H Drawer Bottom | M Drawer Front/Back x7 | |
| E Top | I Top Drawer Front | J Drawer Side Top Side Left | |

If any of these parts arrived damaged, please call us at **1-800-533-7347** and we will send a replacement part out.

For additional strength dab wood glue on tip of screws before attaching.

Hardware Included



Cams **x14**



Connecting Bolts **x14**



Drawer Runners **x8**



DrawerCams **x2**

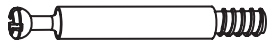

Drawer Connecting Bolts **x2**



#6x1"
Flathead Screw **x32**



#10x1-1/4"
Flathead Screw **x28**

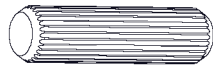

Wood dowel **x2**



Door Magnet **x1**



#6x5/8"
Gold Panhead Screws **x2**



#4x1/2"
Gold Flathead Screws **x14**



#8x5/16"
Flathead Screws **x4**

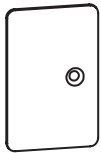

Strike Plate **x1**



#4x1/2"
Bronze Flathead Screw **x1**

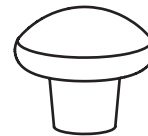

Door Knob **x2**



#8/32x1"
Door Knob Bolt **x2**

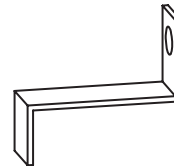

Drawer Stoppers **x4**



Metal Dowels **x4**

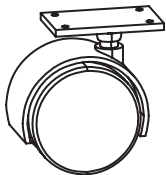
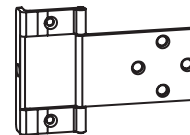

Plate Casters **x4**



#8x1/2"
Silver Panhead Screws **x16**



Door Hinge **x2**

Note: Screws are included in the bag of parts they will be used with.

*Items not drawn to scale.



Tools required

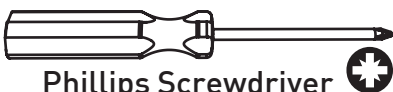

Phillips Screwdriver



Hammer

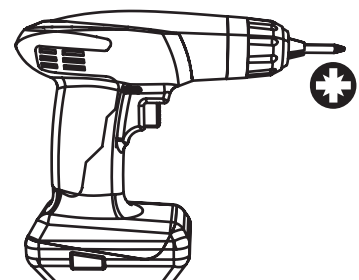

Electric screwdriver

Understanding How the "ARROW-LOC" Cam Fastener Works

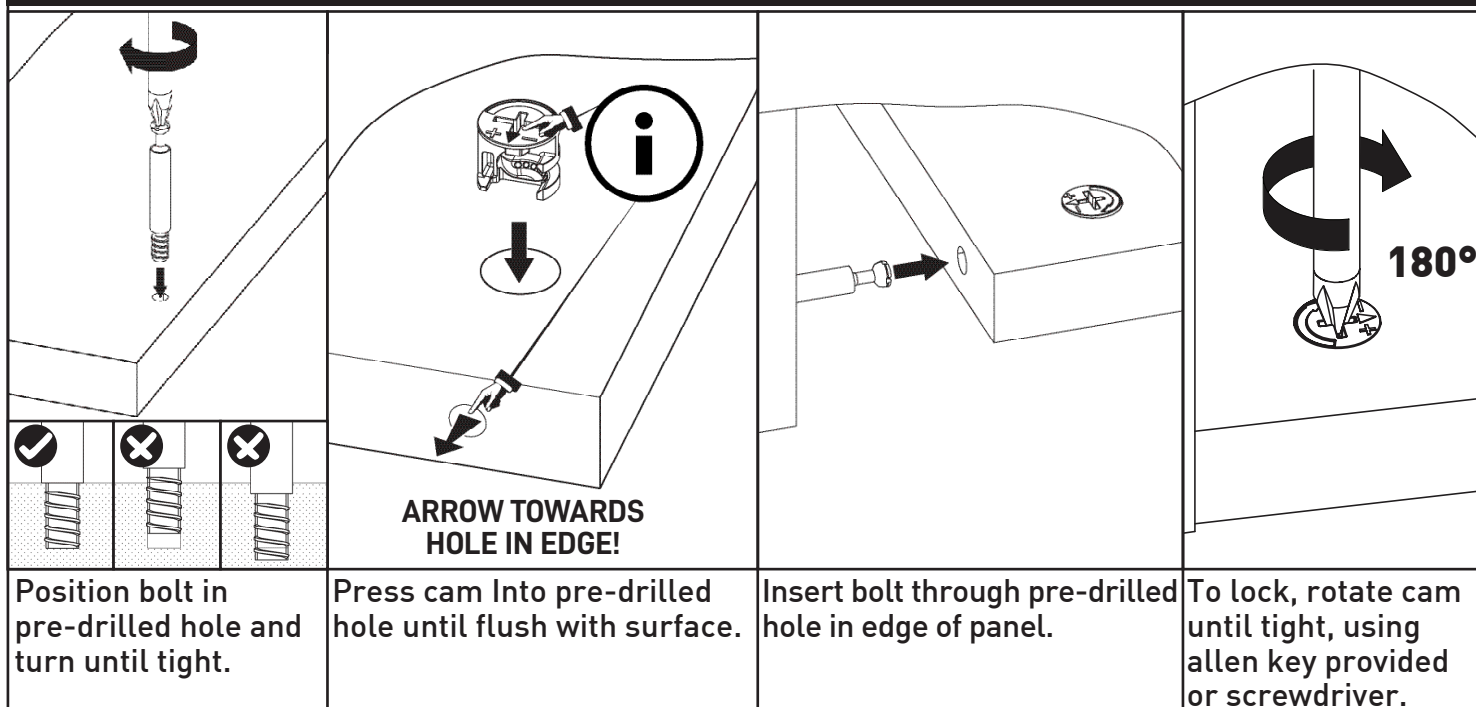

Cabinet Assembly

Step 1. Place Top (E), Bottom (F), Back (B), Left and Right Sides (C, D) on a flat protected surface (to prevent scratching of part). Thread Connecting Bolts (12 total) into pre-drilled holes (as shown in FIG. 1). Install Cams (12 total) by pushing a Cam

into each hole flush with surface. The arrow on the Cams should be turned to face the hole, in each edge where the Connecting Bolts will enter, using a regular screwdriver or Allen Key provided. Attach on Door (G) Door Hinges (x2) using #4x1/2" Gold Flathead Screws (x6).

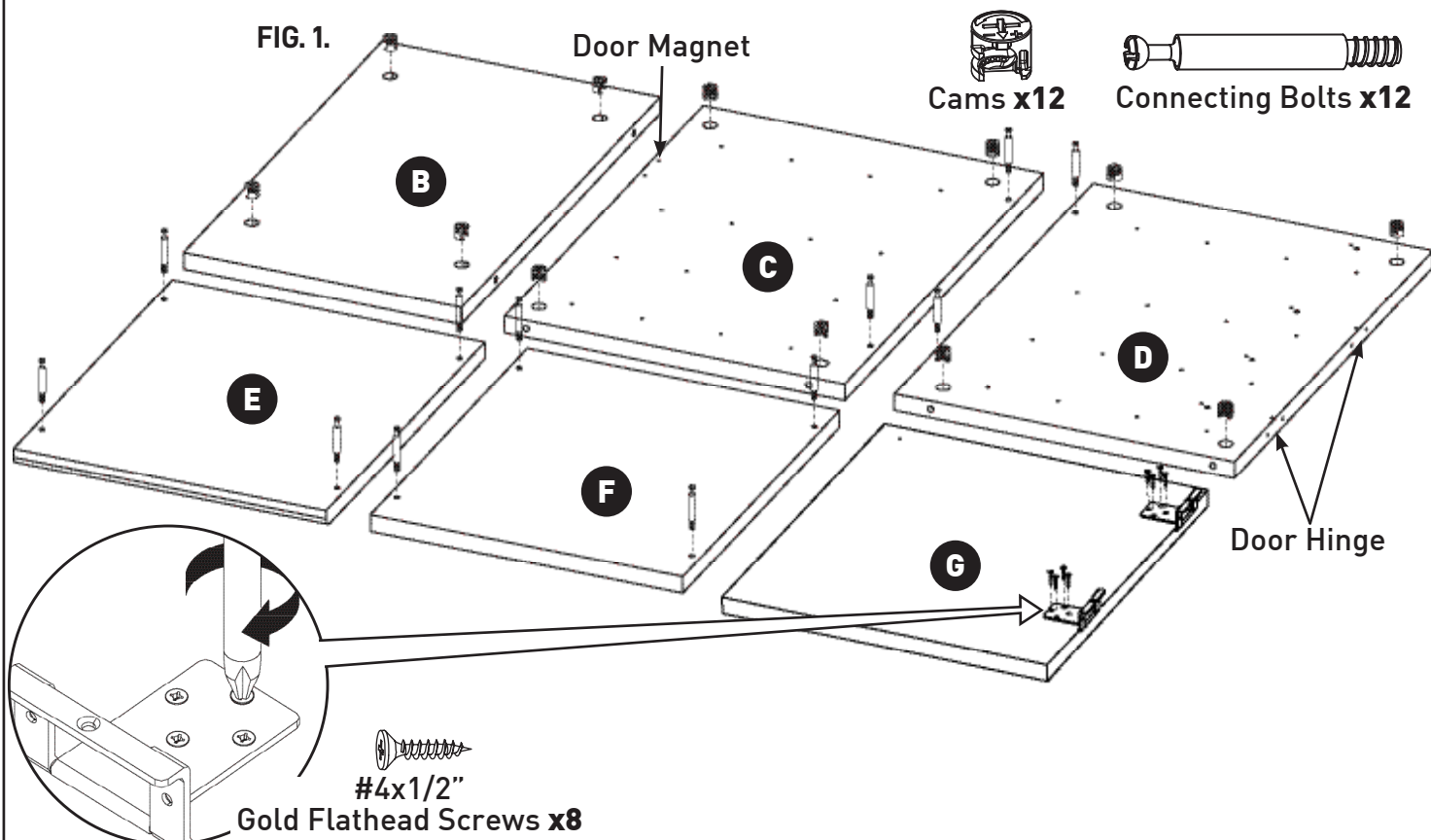

Step 2. Attach Drawer Runners (x8) to Left and Right Sides (C,D) using #6x1" Flathead Screws (x32). Attach Door Magnet (x1) on Left Side (C) using

#6x5/8" Gold Panhead Screws (x2) (as shown in Fig. 2). The metal side of the magnet faces panel edge.

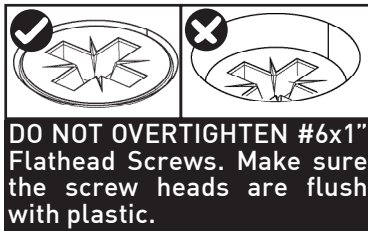
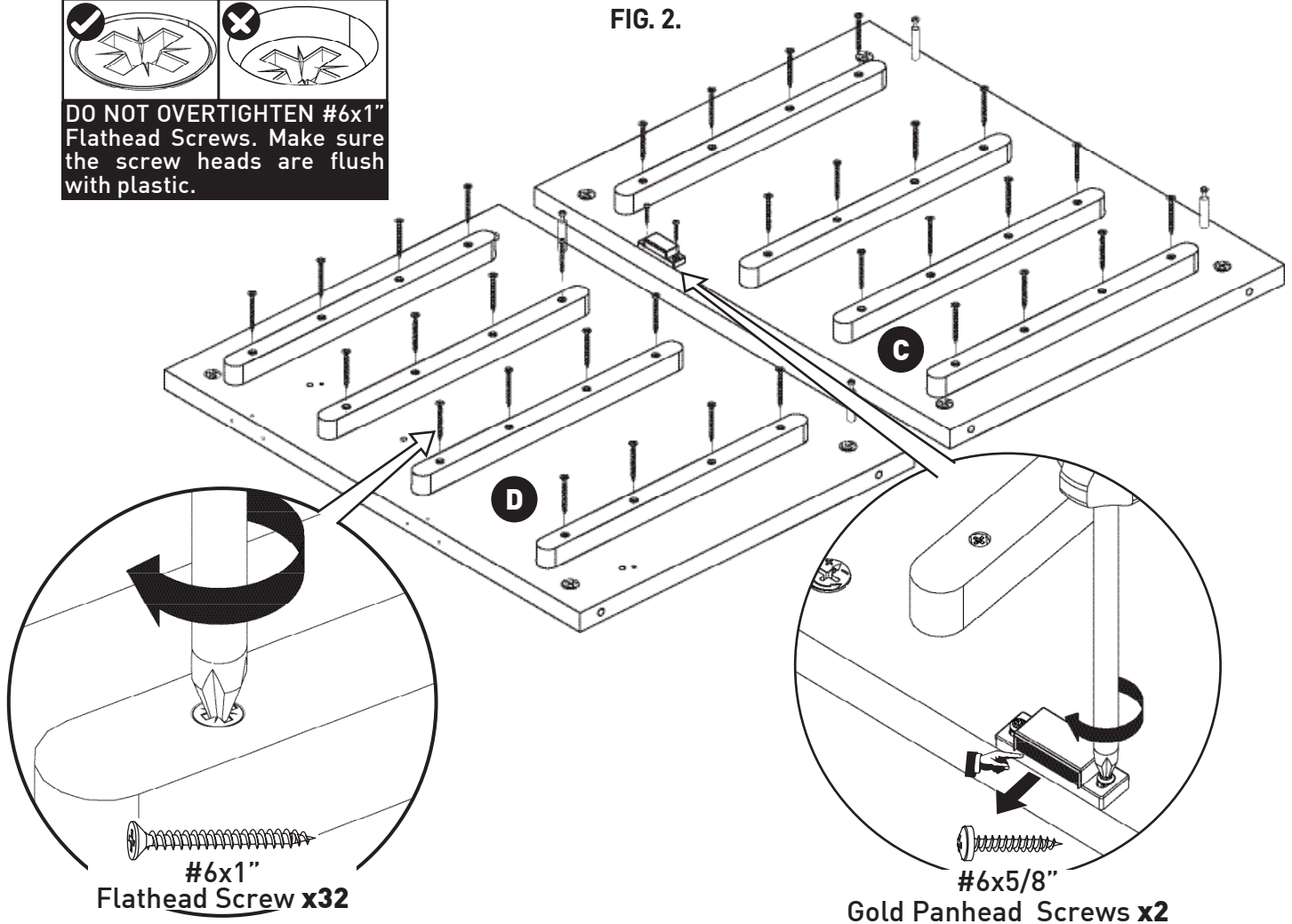

FIG. 2.



Step 3. Screw drawer stops (x4) into Right Side Panel (D) above drawer runner using #8x5/16" Flathead screws (x4). DO NOT tighten the screws completely, leave 1/4" for up and down swivel of the drawer runner.

Insert (4) metal dowels into pre-drilled hole next to drawer stop.

FIG. 3.

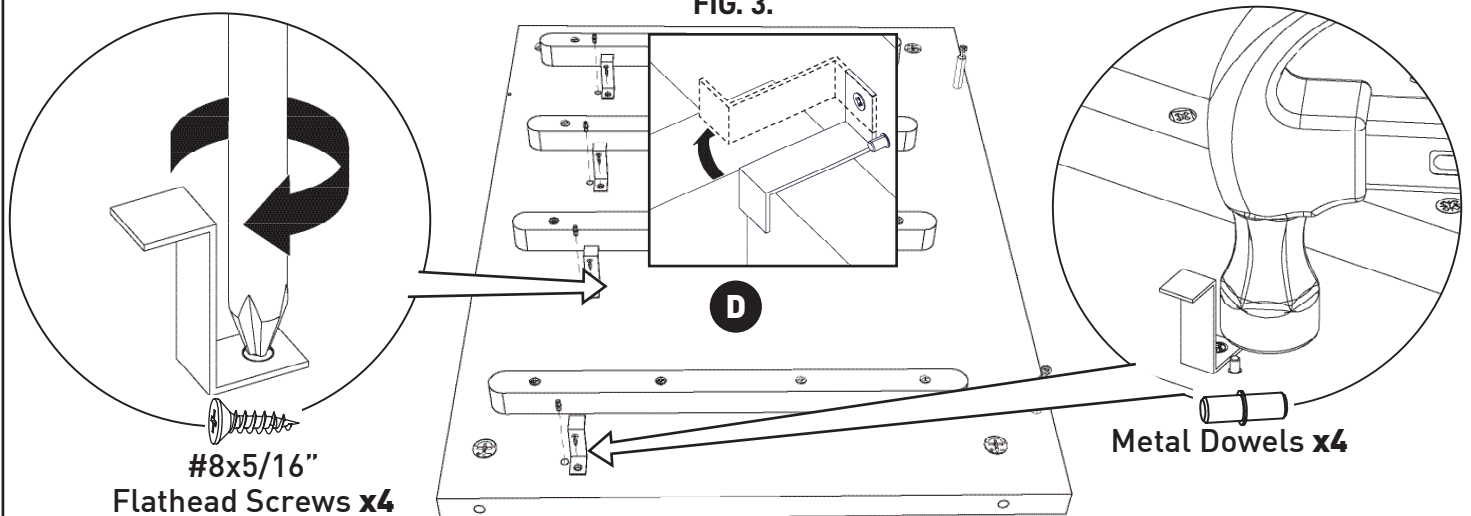

Step 4. Attach Plate Casters (x4) to Bottom (F) using #8x1/2" Silver Panhead Screws (x16) into holes provided (as shown In FIG.4).

For additional strength dab wood glue on the tip of screws before attaching.

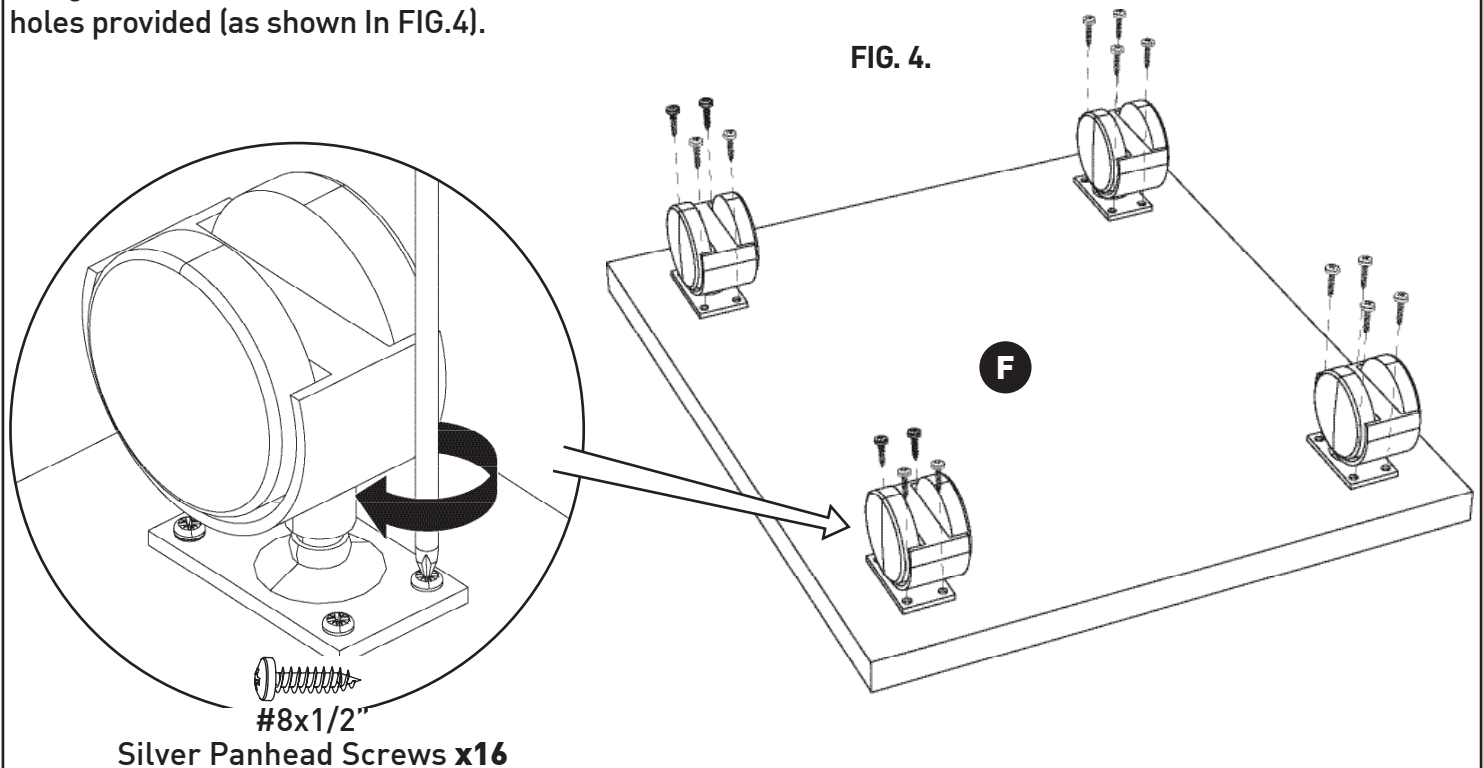

Step 5. With Cams facing inward, attach Left Side (C) to Back (B), guide Connecting Bolts into holes in Back (B), turn Cams to locked position. Attach Right Side (D) to Back (B), guide Connecting Bolts

into holes in Back (B), turn Cams to locked position (as shown in Fig.5). Sides and back will be flush at the top.

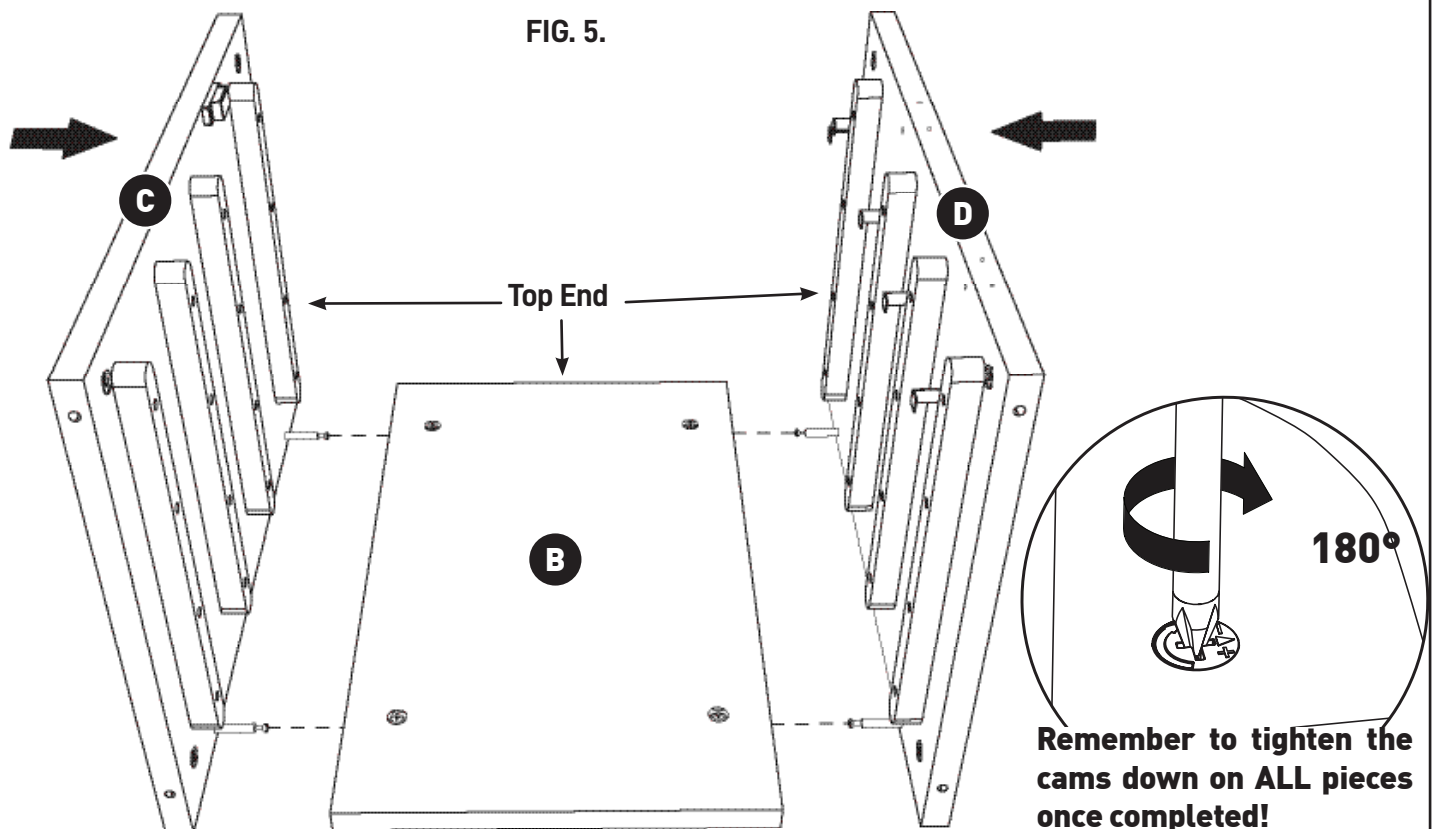

Step 6. Place Top (E) on the floor, guide sides (C,D) and Back (B) assembly onto Connecting bolts with the opening facing the tapered edge of Top panel (E), turn Cams to locked position. Attach Bottom (F) w/casters, guide Connecting Bolts into holes in sides (C,D), turn Cams to locked position (as shown in FIG. 6).

Note: Caddy is being assembled upside down.

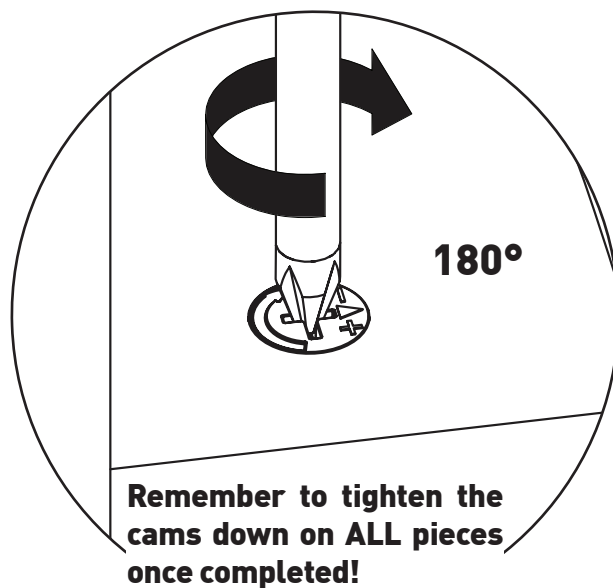
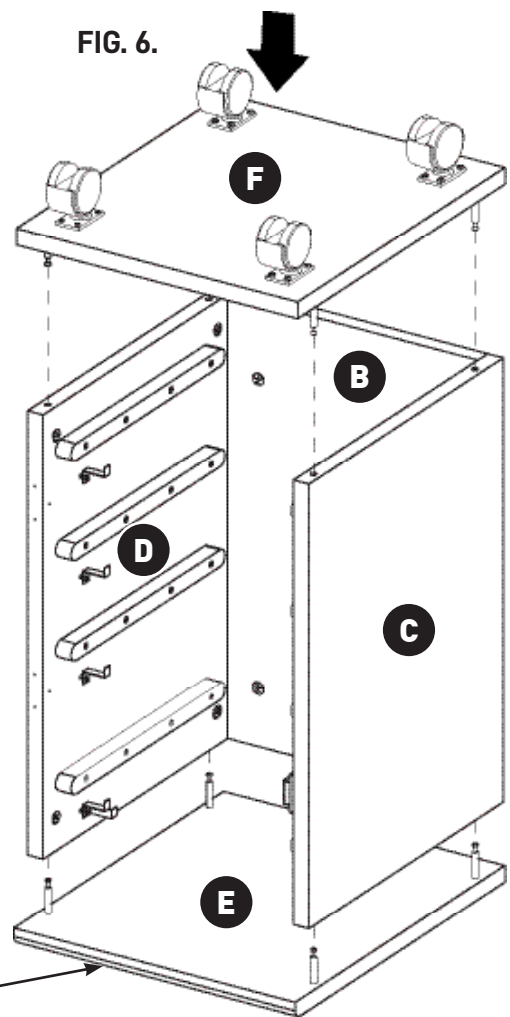

FIG. 6.



Tapered edge facing forward.

Step 7. Laying Caddy on its Back (B), attach Door (G) using #4x1/2" Gold Flathead screws (x8). Attach Door Knob onto the Door (G) as shown below in FIG. 7. Attach Strike Plate with #4x1/2" Bronze Flathead screw (x1), to Door (G).

FIG. 7.

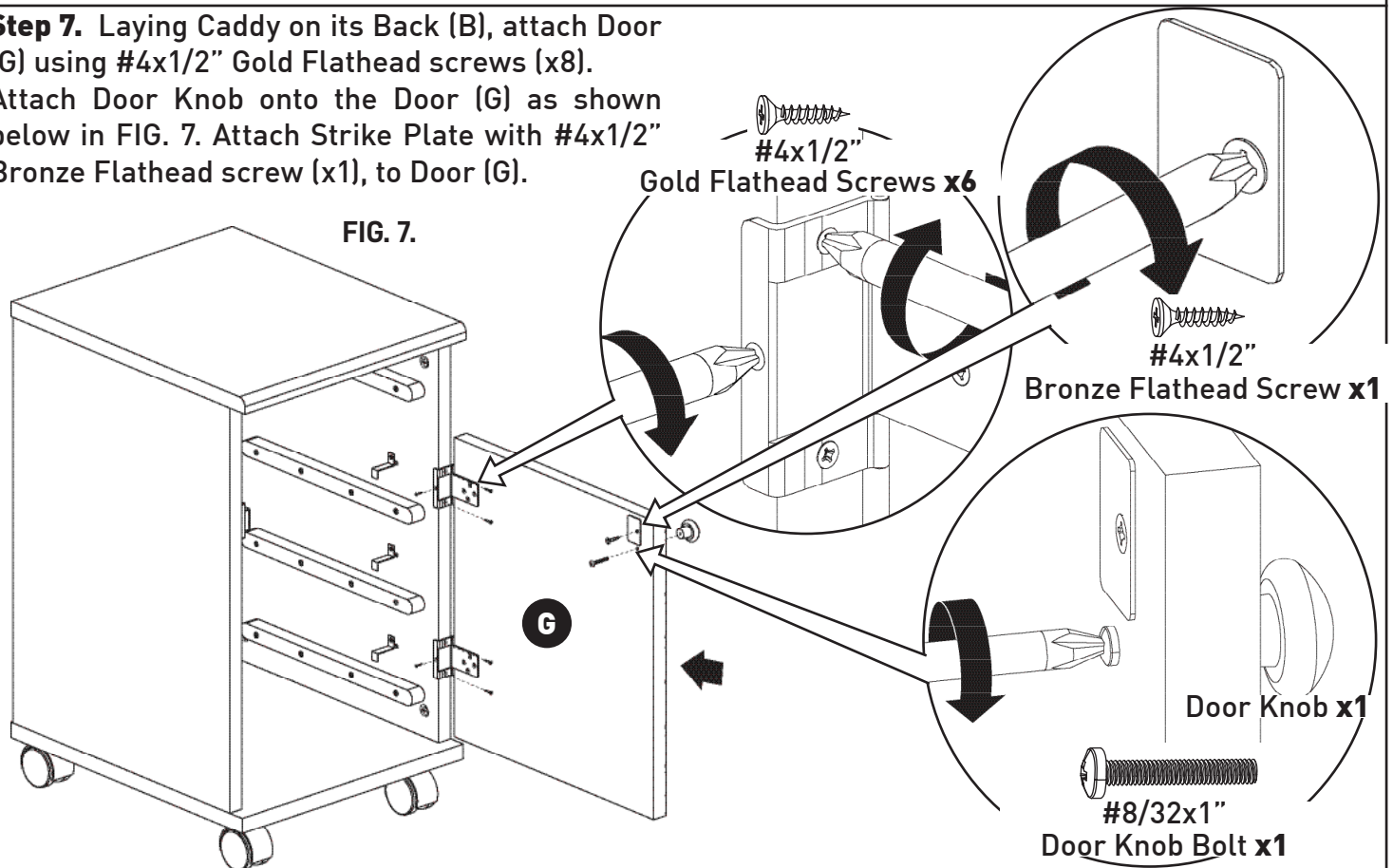

Step 8. Thread Connecting Bolts (2 total) into pre-drilled holes in Top Drawer Front. Install Cams (2 total) in Drawer side (Kx1, Jx1) by pushing a Cam into each, hole flush with surface (as shown in FIG. 8).

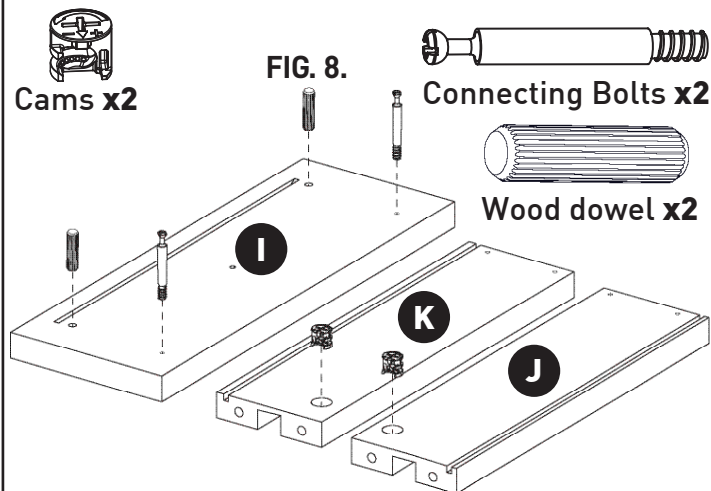

Step 9. Attach Top Drawer Sides (K,J) to Top Drawer Front (I) and Drawer Front/Back (M). Align Drawer Bottom grooves in Sides with Drawer Bottom groove In Drawer Front (as shown in FIG. 9).

Slide Drawer Bottom (H) along grooves on the Sides Into the Groove In Drawer Front (I). Attach Drawer Back (M) to Drawer Sides (K,J), guide Connecting Bolts into holes in Drawer Sides (K,J), turn Cams to locked position. On the other side, attach the Drawer sides (K,J) to Drawer Back (M) with the #10x1-1/2" Flathead Screw (as shown in FIG. 10).

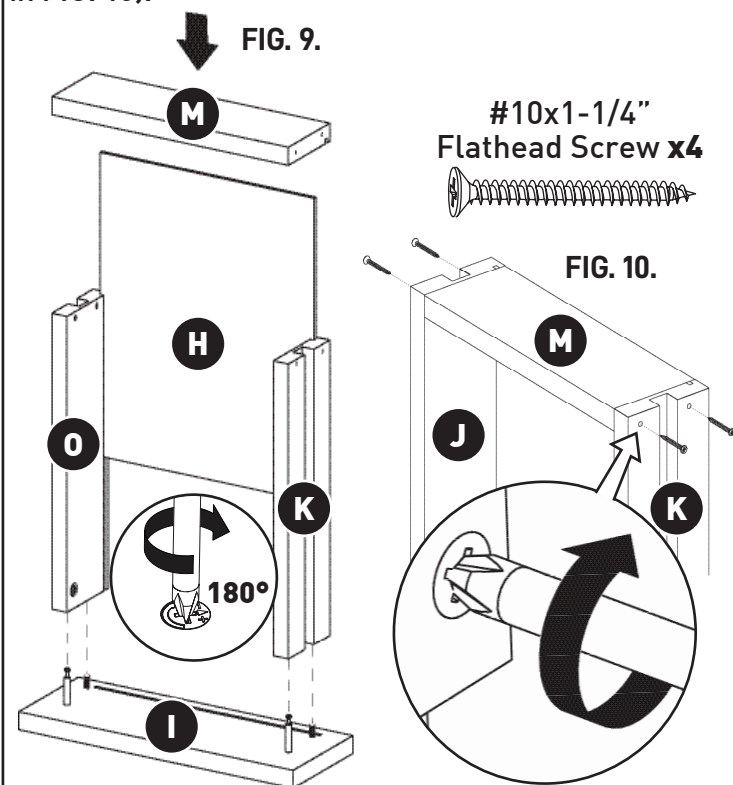

Step 10. Attach Drawer Sides (L) to Drawer Front/Back (M). Align Drawer Bottom grooves in Sides with Drawer Bottom groove In Drawer Front (as shown in FIG. 11). Slide Drawer Bottom (N) along grooves on the Sides Into the Groove In Drawer Front/Back (M). Attach the Drawer sides (L) to Drawer Front/Back (M) with the #10x1-1/2" Flathead Screw (as shown in FIG. 12).

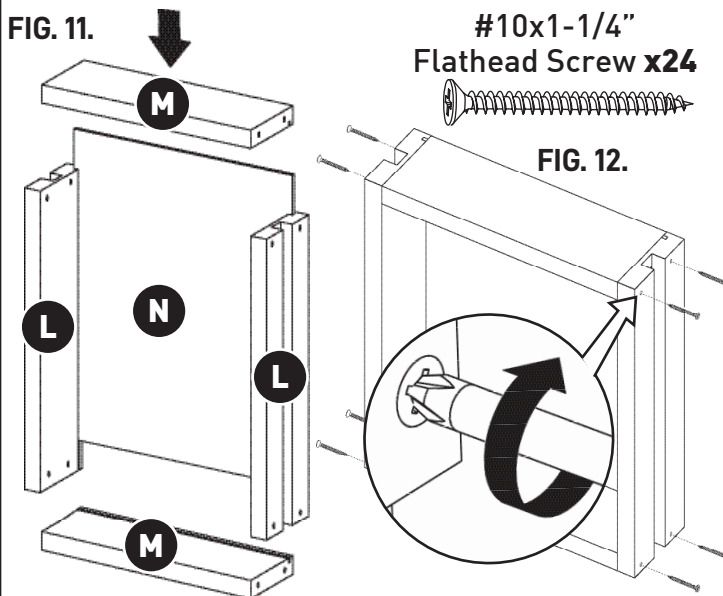

Step 11. Attach the Knob to the Top Drawer Front (I) using 8/32x1" Bolt (x1) for Knob (as shown in FIG. 13).

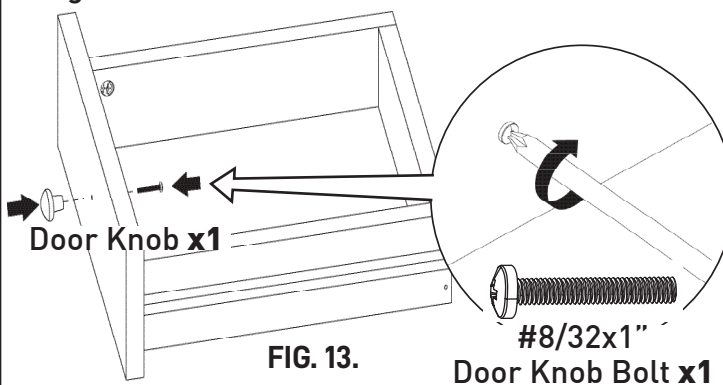

The Drawers may now be insatalled into your cabinet.

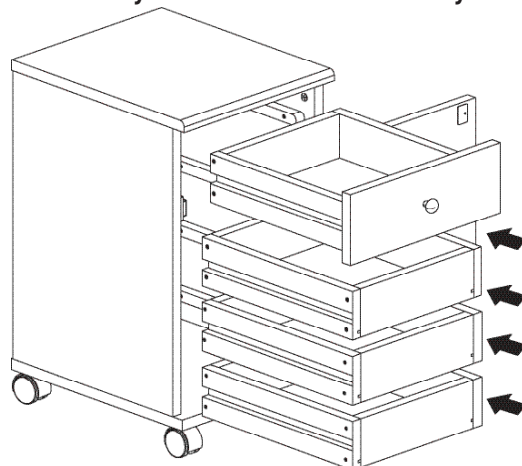

*Drawers may be tight with first use, rub wax paper or ivory bar soap lightly over drawer runners to resolve

Wood Parts and Part Numbers

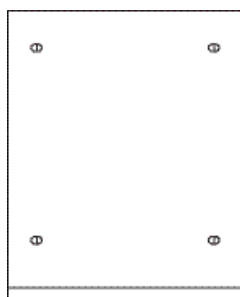

B Back

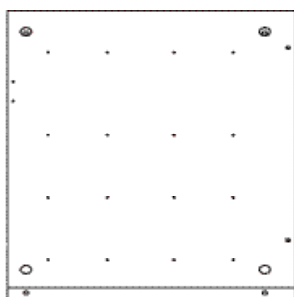

C Left Side

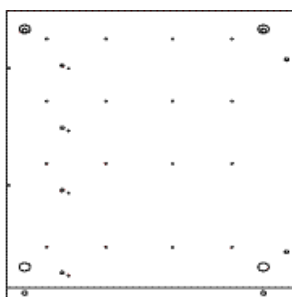

D Right Side

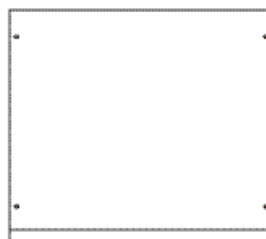

E Top

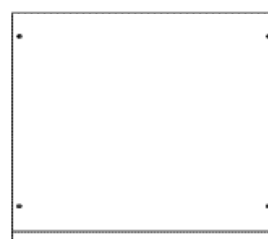

F Bottom

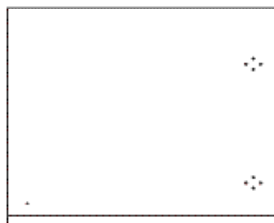

G Door



H Top Drawer Bottom

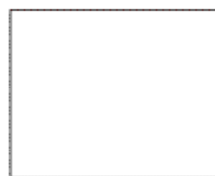

N Drawer Bottom

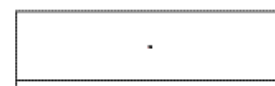

I Top Drawer Front



J Top Side Left



K Top Side Right



M Drawer Front/Back

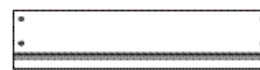

L Drawer Side

Ref.	Description	Part#	Part#	Part#	Part#	Part#	Part#
	Cabinet Model#	800 (Oak)	801 (White)	802 (Cherry)	803 (Black)	804 (Green)	809 (Blue)
B	Back	003315	003252	003315C	003315B	003315G	003323B
C	Left Side	003314	004020	003314C	003314B	003314G	003323B
D	Right Side	003313	003250	003313C	003313B	003313G	003313BL
E	Top	003317	003254	003317C	003317B	003317G	003317BL
F	Bottom	003316	003253	003316C	003316B	003316G	003316BL
G	Door	003318	003255	003318C	003318B	003318G	003318BL
H	Drawer Bottom- Top Drawer	003162	003162	003162	003162	0033162	0033162
I	Top Drawer Front	003320	003257	003320C	003320B	003320G	003320BL
K	Drawer Side/ Top Right	800K	801K	802K	803K	804K	805K
J	Drawer Side/ Top Left	8000	8010	8020	8030	8040	8050
M	Drawer Front/Back	003323G	003322W	003322C	003322B	003322G	003322BL
L	Drawer Side	003323	003323W	003323C	003323B	003323G	003323BL
N	Drawer Bottom	800N	801N	802N	803N	804N	805N

Hardware Included with Part Numbers

A #8x1/2" Silver Panhead Screws



R Drawer Runners



B #4x1/2" Flathead Screws



Y #10x1-1/4" Flathead Screw



Z Wood dowel



C #8x5/16" Flathead Screws



D Drawer Stoppers



O/P/Q Door Hinge

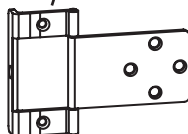

E #6x1" Flathead Screw



F #6x5/8" Gold Panhead Screws



G Connecting Bolts

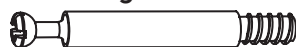

H Drawer Connecting Bolts

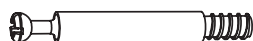

I #4x1/2" Bronze Flathead Screws



J Metal Dowels



K Cams



L Drawer Cams



M Plate Casters

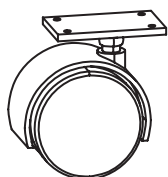

T/U/V/W Door Knob



X #8/32x1" Bolt



N Magnet



S Strike Plate

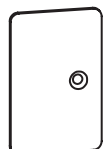

Item	Description	Part No.
A	#8x1/2" Panhead Screw	002614
B	#4x1/2" Flathead Screw	002705
C	#8x5/16" Flathead Screw	002000
D	Drawer Stopper	002001
E	#6x1" Silver Flathead Screw	001325
F	#6x5/8" Gold Panhead Screw	000083
G	Connecting Bolts	002892
H	Drawer Connecting Bolts	000709
I	#4x1/2" Bronze Flathead Screws	000916
J	Metal Dowel	002002
K	Cam	000709
L	Drawer Cam	000709
M	Plate Caster	002190
N	Magnet	001644
O	Door Hinge- Silver	000709
P	Door Hinge- Gold	000709
Q	Door Hinge- Bronze	002730
R	Drawer Runner	002397
S	Strike Plate	002192
T	Knob Gold (Model 800/802)	003170
U	Knob Silver (Model 801/803)	003165
V	Knob - Pistachio Green (Model 804)	000709
W	Knob - Blue (Model 809)	000709
X	8/32x1" Bolt	003192
Y	#10x1-1/2" Flathead Screw	800Z
Z	Wood dowel	800W

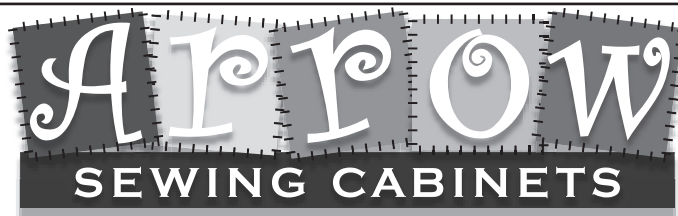

Accessories to Complete Your Sewing Experience

Custom Insert

Enhance your sewing experience with a custom-made insert for your Arrow or Kangaroo cabinet. Inserts are designed to reduce the gap between the machine and cabinet opening. This provides an ergonomic work surface for the free arm of the sewing machine, allowing for straighter stitches, less fatigue and an overall better experience using your machine and cabinet.

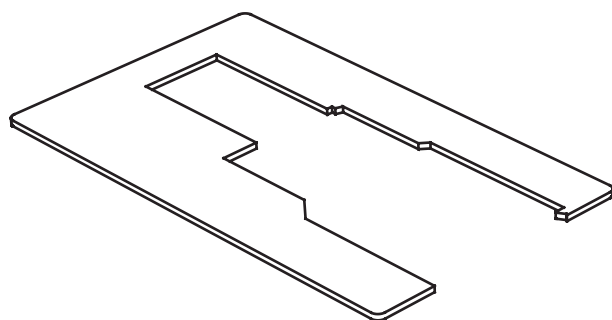

Insert

Arrow Sewing Chairs

Our sewing chairs are designed to provide comfort, support, and the fashionable look you want for your space. Our chairs are the perfect accessory for any craft and sewing room and are offered in several fabric and color options. "They provide necessary lumbar support and comfort for long term sewing. Arrow chairs also have a hidden storage compartment under the seat, perfect for hiding small notions, patterns, and anything else you need.

Visit your local Arrow dealer or arrowcabinets.com for ordering information.

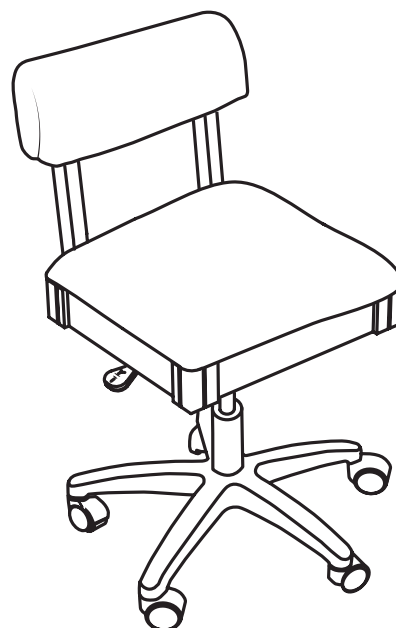

Hydraulic Sewing Chair

P.O. Box 307 Delavan, WI 53115
1-800-533-7347
cs@arrowcabinets.com
www.arrowcabinets.com