



KANGAROO™  
sewing furniture

## ASSEMBLY INSTRUCTIONS

# Aussie II

ITEM NO.: K8605 Teak  
K8611 White

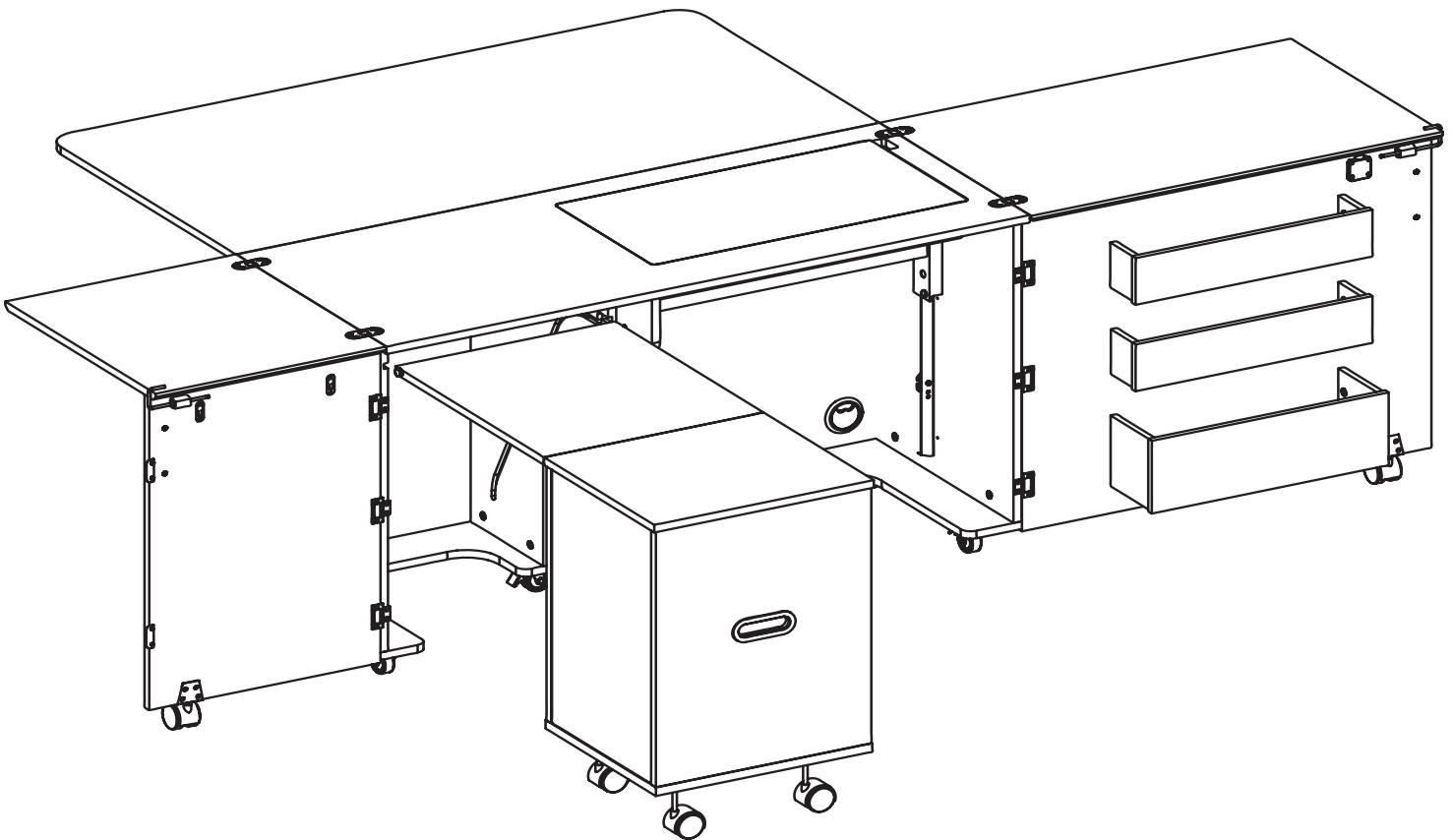

SEW IN COMFORT. SEW LONGER.™

Read the instructions carefully before starting. Please open and inspect the contents of boxes to see that all parts are included. You will need a Phillips head and a flat head screwdriver. A power screwdriver or cordless drill is preferable. Ensure that the Phillips head fits neatly and fully engages the screw to avoid damage to the screws. Make sure that you tighten all screws securely and tap wooden dowels all the way in.

### Use and Care

Your cabinet normally requires a minimum amount of maintenance; however, the following points are worth noting:

**Cleaning** - To remove marks and enhance the surface, wipe with general purpose cleaner.

**Caution** - Do not use ammonia-based cleaning agents. Do not use harsh chemicals or abrasive cleansers. The surface can be wiped with a damp cloth but should be dried quickly.

**Electrical and Hydraulic Lifts** - Require annual lubrication.

## Understanding How the Cam Fastener Works

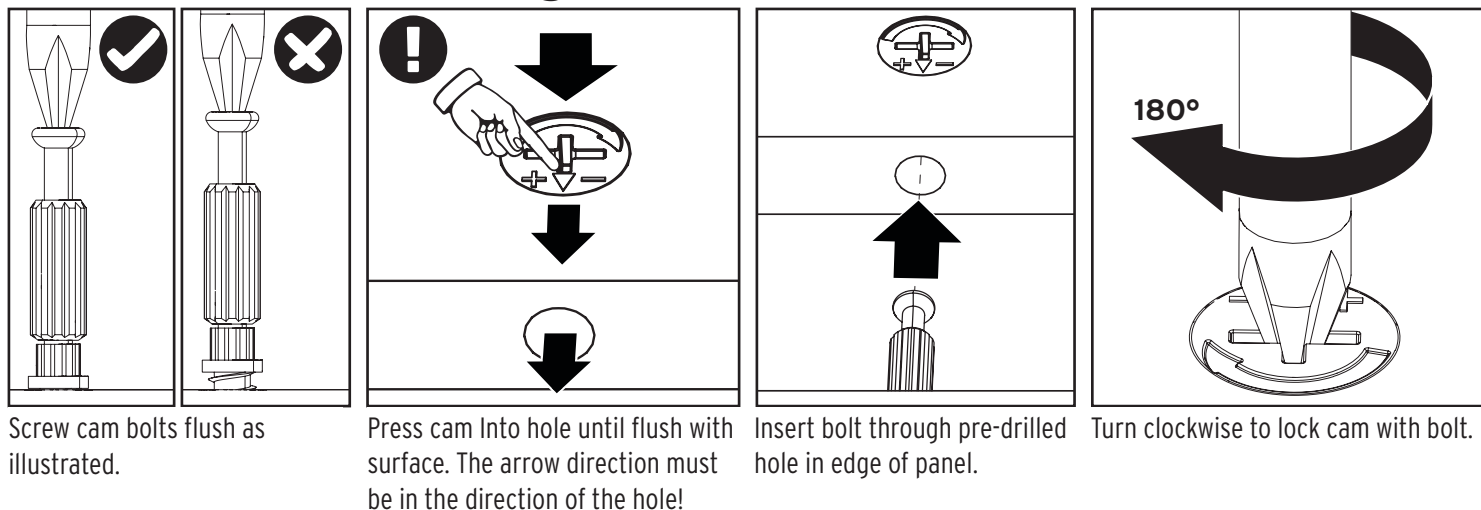

# Parts List

ITEM	DESCRIPTION	QTY.	PACK.	ITEM	DESCRIPTION	QTY.	PACK.
<b>A</b>	Top Panel	1	1 of 4	<b>V2</b>	Right Door Panel	1	3 of 4
<b>A5</b>	Platform Cover	1	1 of 4	<b>Y1</b>	Left Partition Panel	1	3 of 4
<b>B</b>	Right Leaf	1	1 of 4	<b>Y2</b>	Right Partition Panel	1	3 of 4
<b>C</b>	Left Leaf	1	1 of 4	<b>O</b>	Insert Holder	1	3 of 4
<b>G</b>	Bottom Panel	1	1 of 4	<b>O1</b>	Gate Leg	1	3 of 4
<b>A1</b>	Quilt Extension Panel	1	2 of 4	<b>L</b>	Door Bin Front	2	3 of 4
<b>D</b>	Back Panel	1	2 of 4	<b>L1</b>	Door Bin Side	4	3 of 4
<b>X</b>	Left Side Panel	1	2 of 4	<b>L2</b>	Door Bin Bottom	2	3 of 4
<b>Z</b>	Right Side Panel	1	2 of 4	<b>K</b>	Large Bin Front	1	3 of 4
<b>A4</b>	Platform	1	3 of 4	<b>K1</b>	Large Bin Side	2	3 of 4
<b>F</b>	Fixed Shelf	1	3 of 4	<b>K2</b>	Large Bin Bottom	1	3 of 4
<b>V1</b>	Left Door Panel	1	3 of 4		Lift & Rails	1	4 of 4

PARTS FOR AUSSIE CADDY LISTED ON PAGE 16 OF THIS MANUAL.

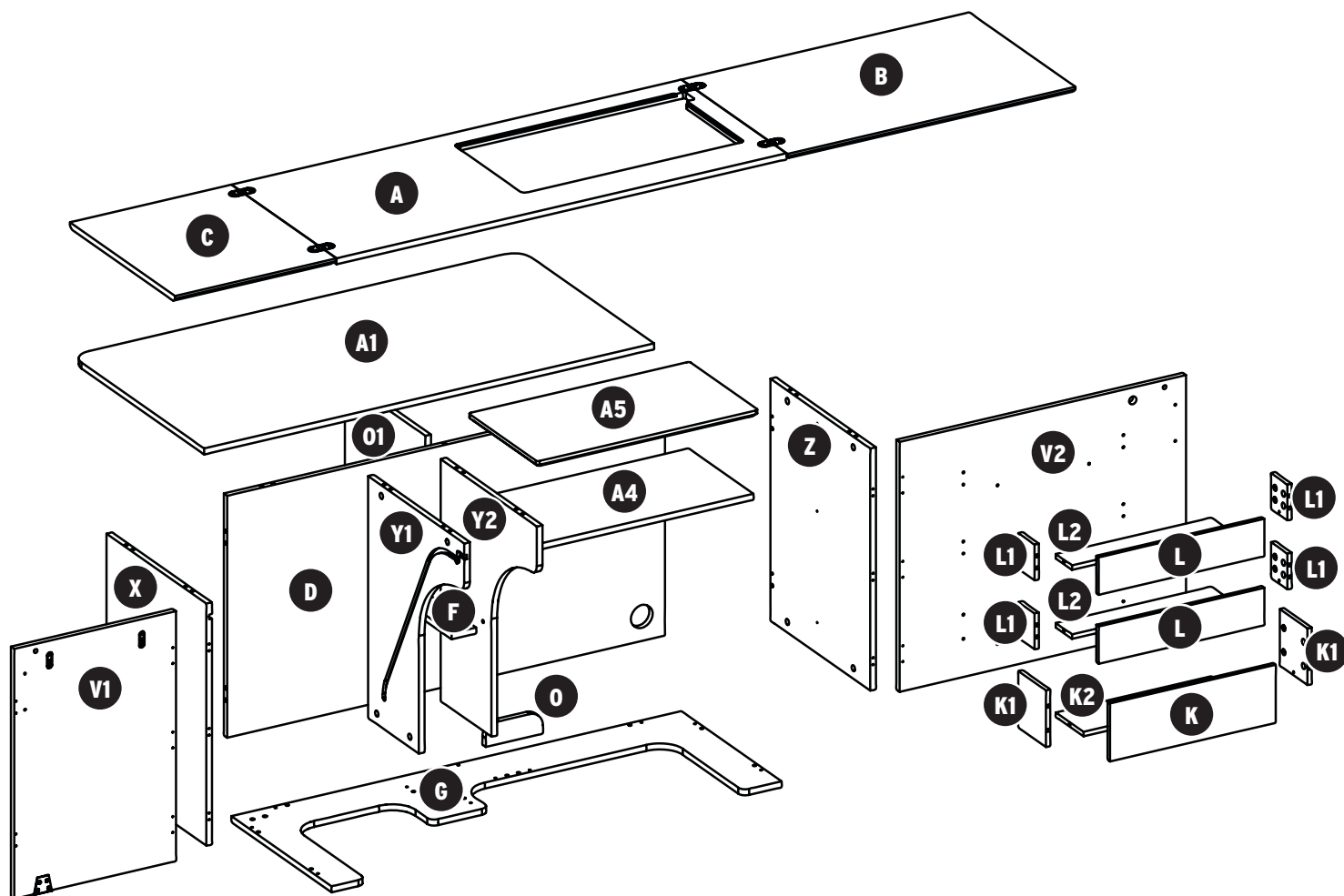

# Parts List

ITEM	DESCRIPTION	QTY.	ITEM	DESCRIPTION	QTY.
<b>c1</b>	6x35 Cam Bolt	28	<b>h</b>	Handle	2
<b>c3</b>	6x25 Cam Bolt	42	<b>d</b>	Door Hook	2
<b>c2</b>	5/8" Cam Cover	70	<b>h1</b>	Butt hinge	2
<b>d1</b>	8x30 Dowel Pin	30	<b>h2</b>	Flush Hinge	6
<b>t2</b>	Locking Plate Caster	5	<b>h3</b>	Flap Hinge	3
<b>a</b>	Wrench	1	<b>b1</b>	8x16 Fix Bolt	20
<b>r3</b>	14mm Spanner	1	<b>b2</b>	4x20 Fix Bolt	4
<b>s1</b>	3.5x14 Screw	44	<b>m</b>	Magnet, Catch Plate	1
<b>s2</b>	3x14 Screw	31	<b>L</b>	Lock, Lock Plate, Keyx2	1
<b>s4</b>	3x20 Screw	4	<b>t1</b>	Caster	3
<b>s5</b>	Alignment Pin	1	<b>d3</b>	Door Plate	2

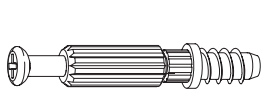

**c1** 6x35 Cam Bolt **x28**



**c2** 5/8" Cam Cover **x70**



**c3** 6x25 Cam Bolt **x42**



**d1** 8x30 Dowel Pin **x30**

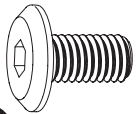

**b1** 8x16 Fix Bolt **x20**



**b2** 4x20 Fix Bolt **x4**



**s1** 3.5x14 Screw **x44**



**s2** 3x14 Screw **x31**



**s4** 3x20 Screw **x4**

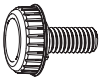

**s5** Alignment Pin **x1**



**a** Wrench **x1**



**h** Handle **x2**



**d3** Door Plate **x2**

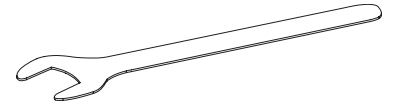

**r3** 14mm Spanner **x1**

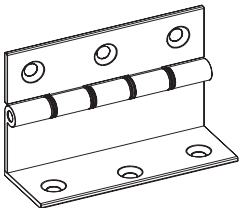

**h3** Flap Hinge **x3**

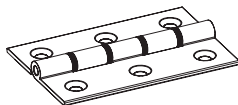

**h1** Butt Hinge **x2**

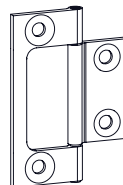

**h2** Flush Hinge **x6**

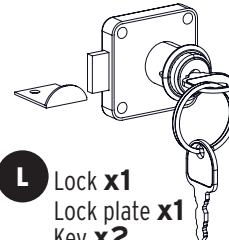

**L** Lock **x1**  
Lock plate **x1**  
Key **x2**

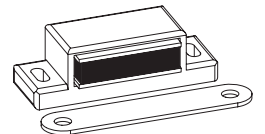

**m** Magnet **x1**  
Catch plate **x1**

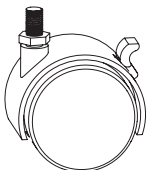

**t1** Caster **x3**

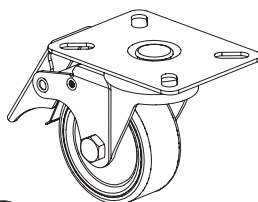

**t2** Locking Plate Caster **x5**

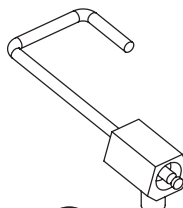

**d** Door Hook **x2**

## Pre-installed parts



**c5**  
Cam

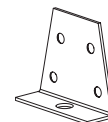

Caster Bracket

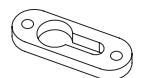

Panel Connector

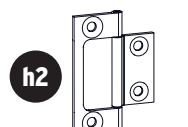
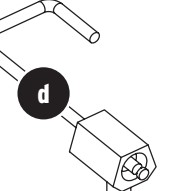
**c1**6x35 Cam Bolt **x11****c3**6x25 Cam Bolt **x18****d1**8x30 Dowel Pin **x16**3x14 Screw **x6**Lock Plate **x1**Lock **x1**  
Key **x2**3x20 Screw **x4**Flush Hinge **x3**Door Hook **x1**Caster **x1**14mm Spanner **x1**Handle **x1**4x20 Fix Bolt **x2****Step 1. Preparation Panels A, D, V2, Y1 and Y2.**

1. Insert cam bolts **c1** into panel **A**.
2. Fix lock plate using screws **s1** to panel **A** as illustrated below. Orient the flat face of the lock plate **L** towards front edge of the panel **A**.
3. Insert dowel pins **d1** into panels **D**, **Y1** and **Y2**.
4. Insert door hook **d** into panel **V2** as illustrated below (it has to be hammered).
5. Insert cams bolts **c3** into panel **V2** as illustrated below.
6. Fix flush hinge **h2** with screws **s2** to panel **V2** as illustrated below.
7. Fix lock mechanism **L** into corner of **V2**. Add trim ring to lock on outside of **V2**. Attach handle **h** to outside of **V2** and secure with bolts **b2**.
8. Screw caster **t1** into caster brackets on **V2** and tighten with spanner **r3**.
9. Attach handle **h** to outside of **V2** and secure with bolts **b2**.

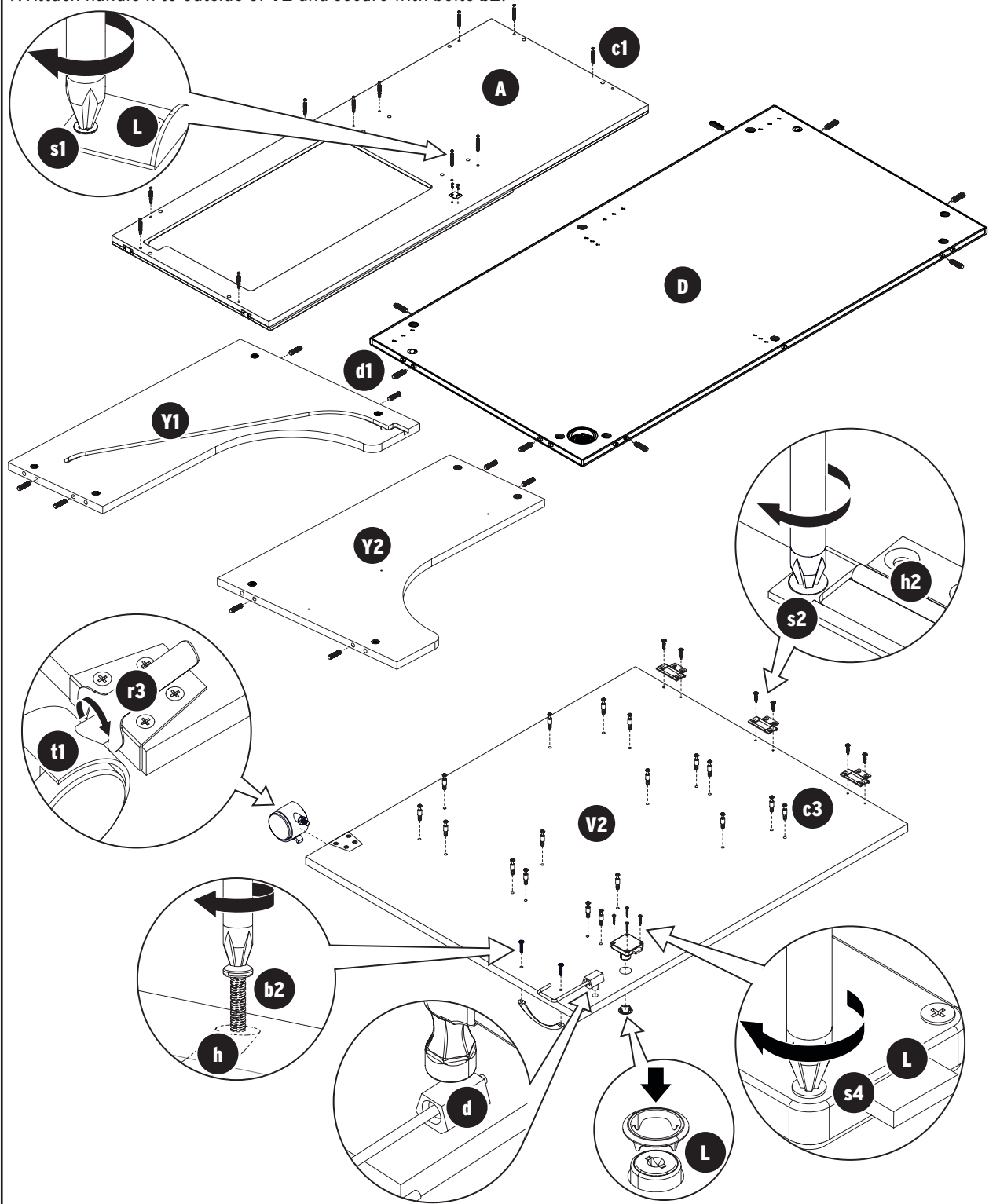



6x35 Cam Bolt **x4**



6x25 Cam Bolt **x24**



8x30 Dowel Pin **x14**



3.5x14 Screw **x17**



3x14 Screw **x12**



Butt Hinge **x2**

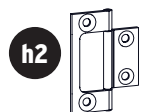

Flush Hinge **x3**

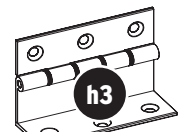

Flap Hinge **x3**



Magnet **x1**

Catch Plate **x1**



Door Plate **x2**

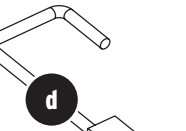

Door Hook **x1**

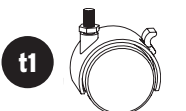

Caster **x2**



14mm Spanner **x1**



Handle **x1**

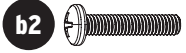

4x20 Fix Bolt **x2**



Alignment Pin **x1**

## Step 2. Preparation Panels A1, O1, X, Z, V1, F, O, L, L1, K, K1.

1. Insert cam bolts **c1** into panels **X** and **Z**.
2. Insert cam bolts **c3** into panels **K**, **K1**, **L** and **L1**.
3. Insert dowel pins **d1** into edges of panels **X**, **Z**, **F** and **O**.
4. Locate pilot holes on panel **A1** and install magnet **m** using screws **s1**. Along top edge of panel **A1**, install flap hinge **h3** with screws **s1** as illustrated below.
5. Attach magnet catch plate **m** to panel **O1** using **s2** screws.
6. Install alignment pin **s5** into edge of panel **O1** and screw. Locate the pilot holes on panel **O1** and install butt hinges **h1** using screws **s1**.
7. Insert caster **t1** into caster bracket on panel **O1** and tighten with spanner **r3**.
8. On panel **V1**, attach three flush hinges **h2** to back edge and door plates **d3** to front edge with screws **s2**.
9. Insert door hook **d** to panel **V1**.
10. On front side of **V1** attach handle **h** and secure with fix bolts **b2**.
11. Locate the pilot holes in panel **O1** and install butt hinges **h1** using **s1** screws.

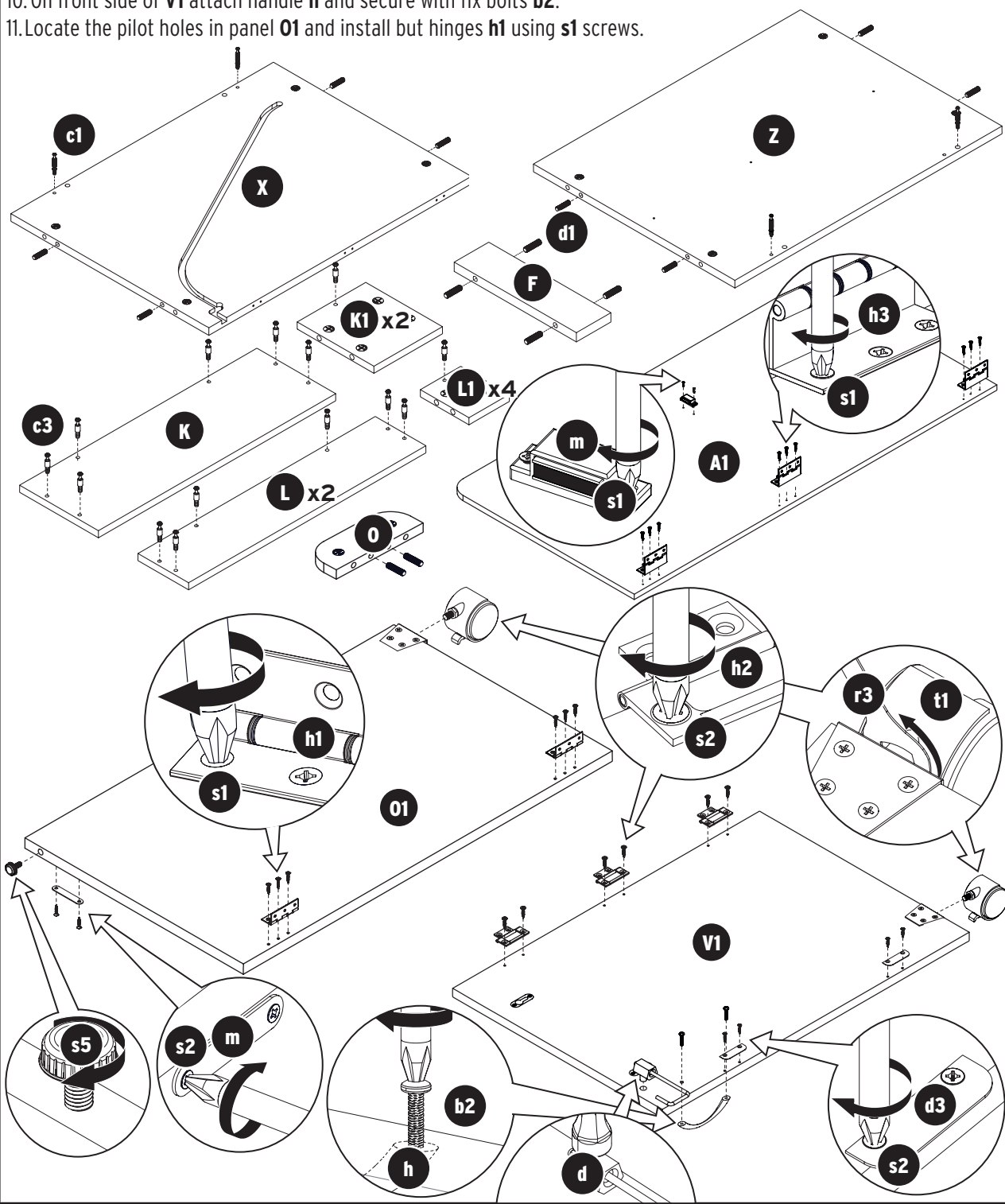

**Step 3.** Fix Lifter Rail (right) to panel **Z** using screws **s1** following predrilled holes as shown on the illustration below.

Lifter Rail (Right) **x1**

**s1**   
3.5x14 Screw **x3**

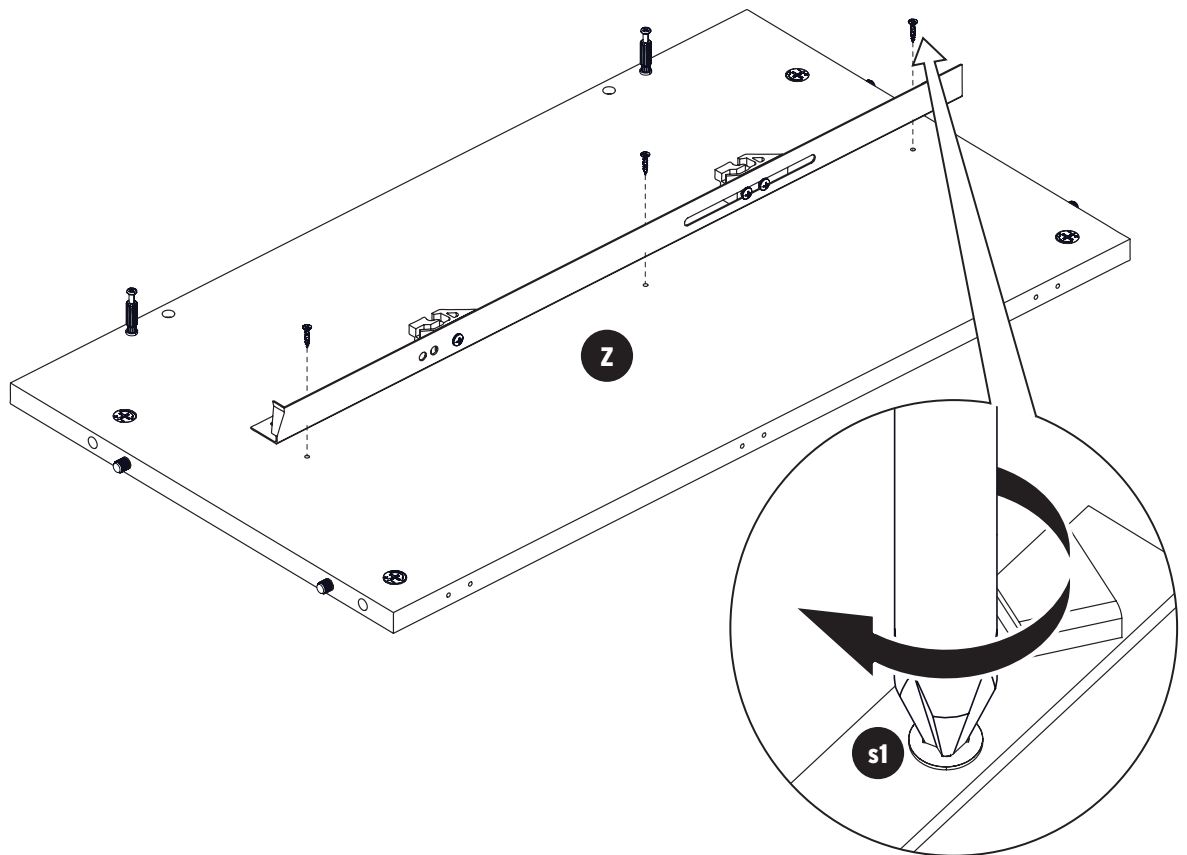

**Step 4.** Fix Lifter Rail (Left) to panel **Y2** using screws **s1** following predrilled holes as shown on the illustration below.

Lifter Rail (Left) **x1**

**s1**   
3.5x14 Screw **x3**

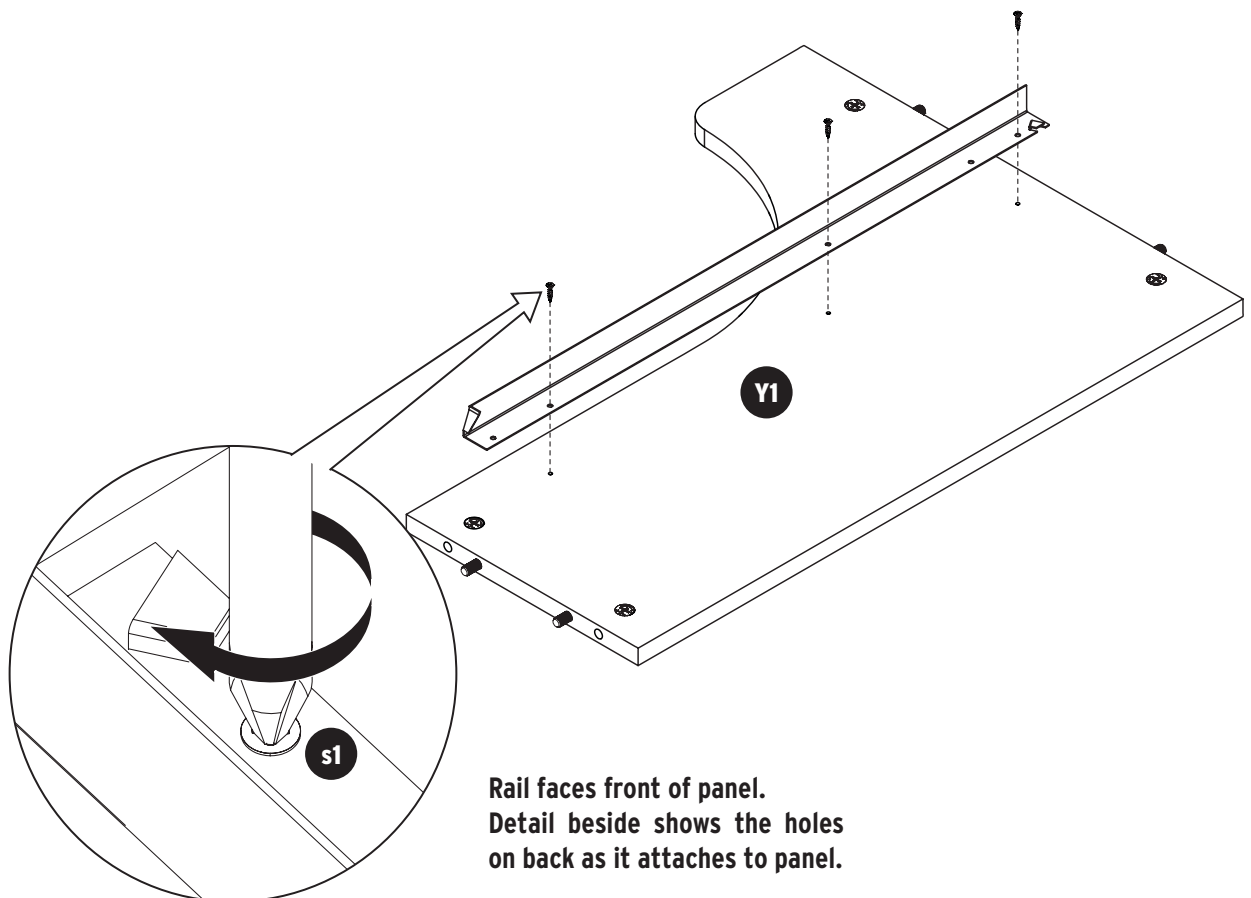





### Step 5. Panels D, X, Z assembly.

Insert cam bolts **c1** on panels **X** and **Z** into cams on panel **D** and tighten in a clockwise direction as illustrated below. Please note the orientation of panel **D** with the cams facing backwards. This is the correct orientation. Apply cam covers **c2** over tightened cams.

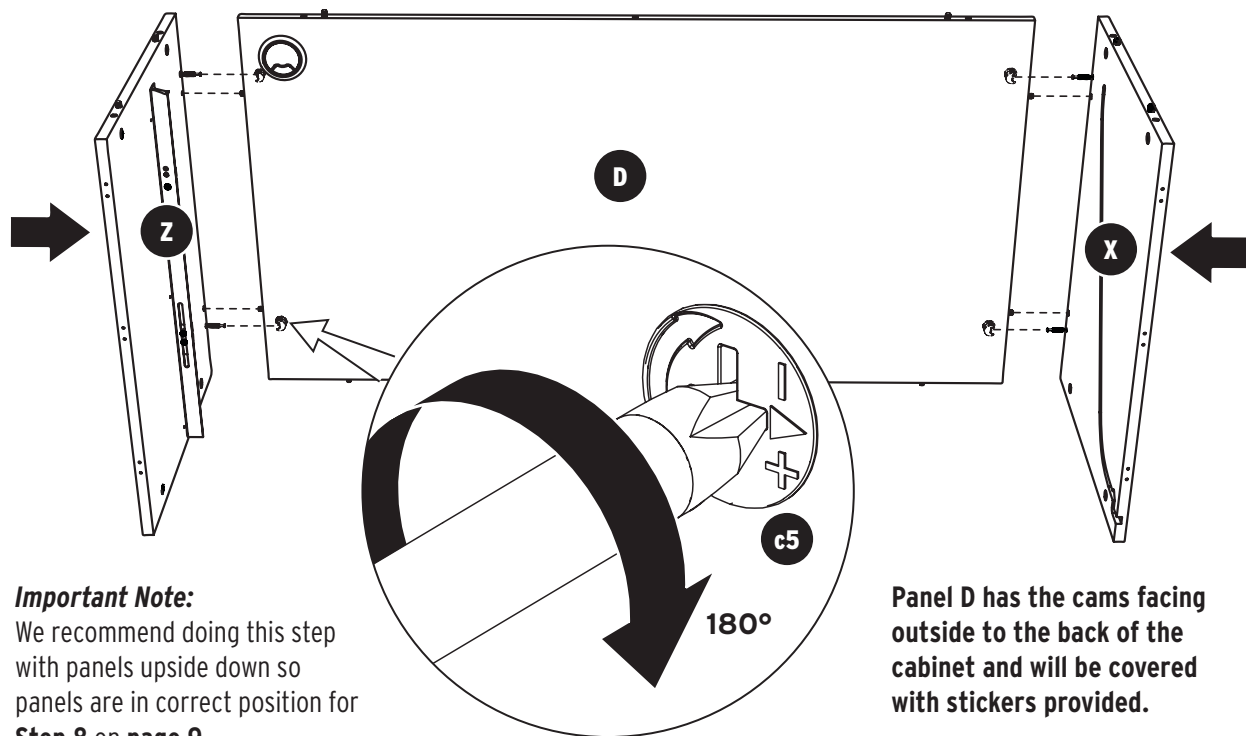

### Step 6. Panel G assembly.

1. Install locking plate casters **t2** using bolts **b1** with **a** wrench. Turn panel over and lock casters for step 2. Flip panel **G** over to top side.
2. On top side view, install **c1** cam bolts as illustrated below.

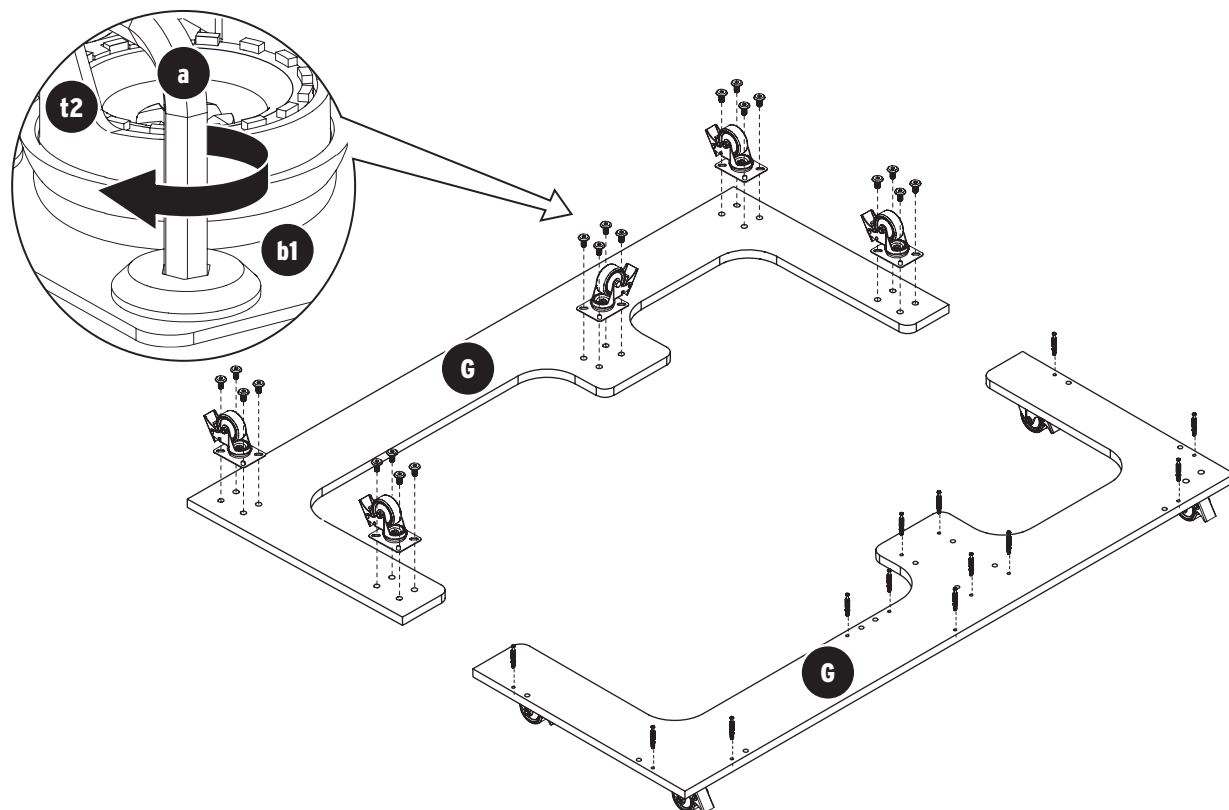
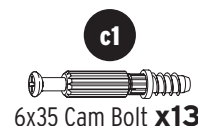



**c2**



5/8" Cam Cover **x4**

### Step 7. Panel G assembly.

Insert cam bolts **c1** on panel **G** into cams on panel **O** and tighten in a clockwise direction as illustrated below. Apply cam covers **c2** over tightened cams.

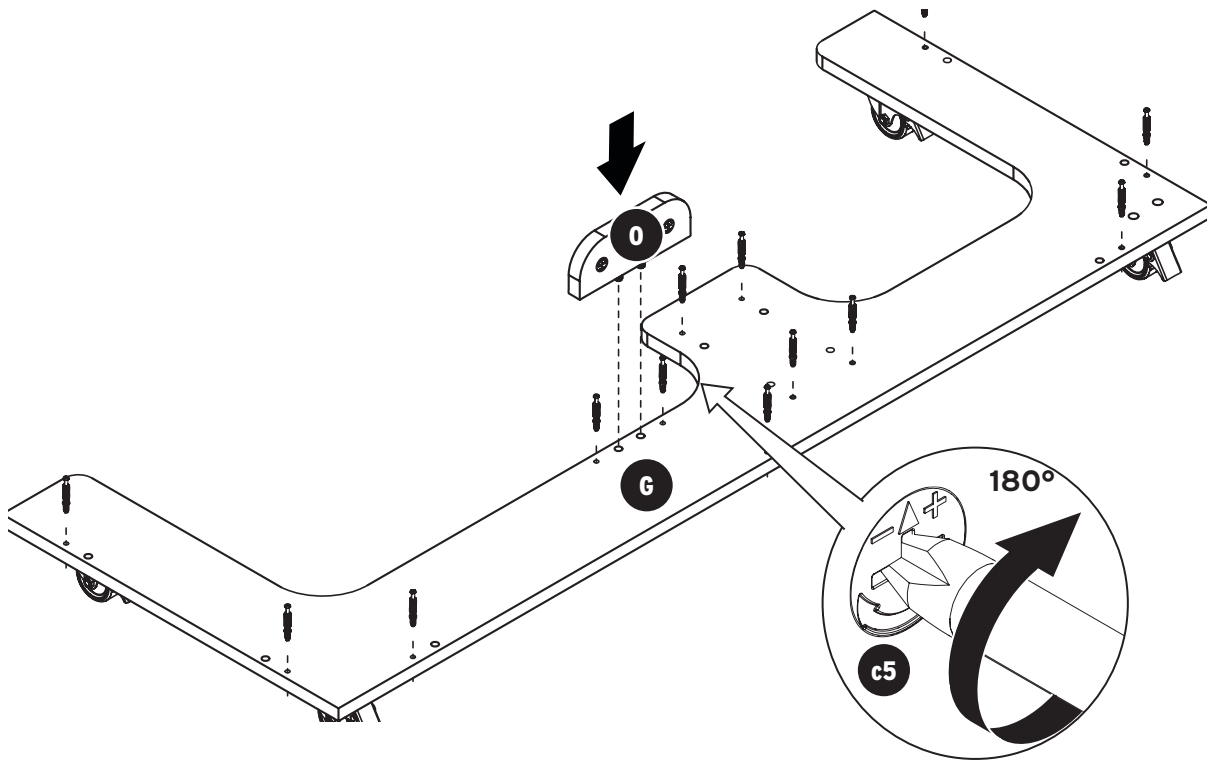

### Step 8. Panel G assembly.

Insert cam bolts **c1** on panel **G** into cams on panels **X**, **Z** and **D** and tighten in a clockwise direction as illustrated below.

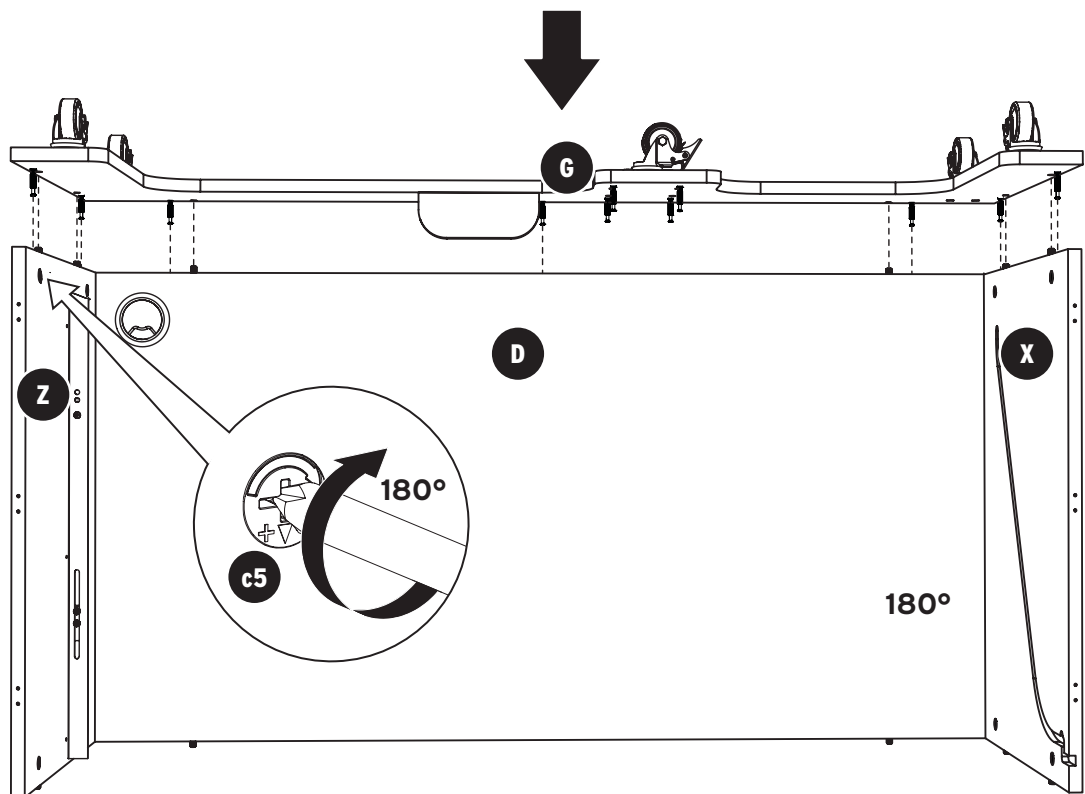

**Step 9. Flip cabinet over (right side up).** We recommend that two people do this step.

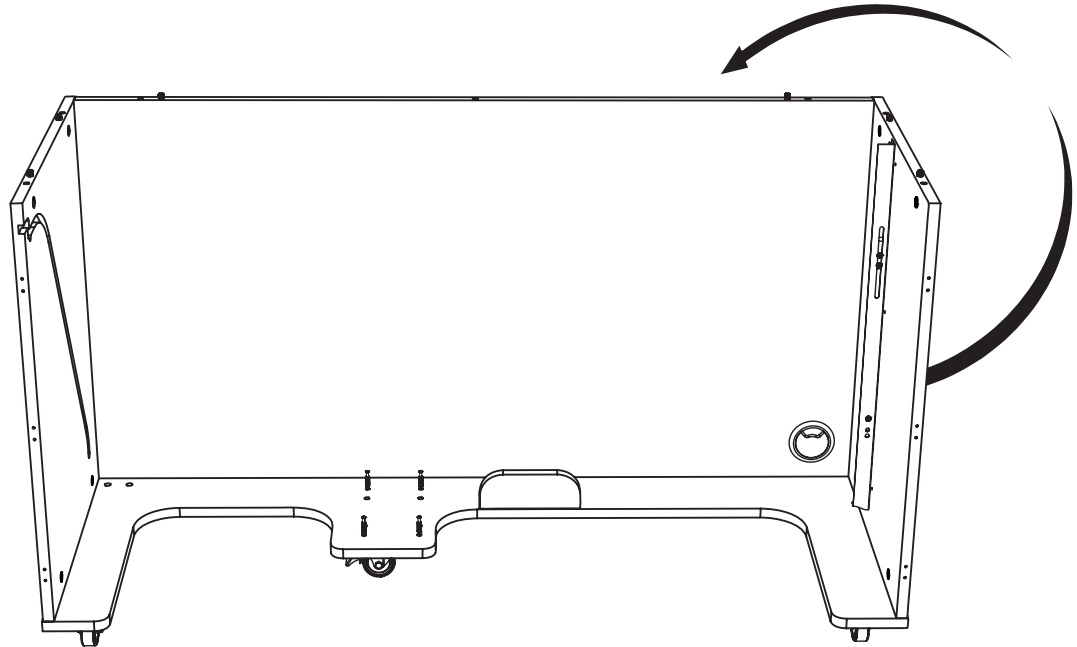

**Step 10. Panel F assembly.**

Insert Dowel Pin d1 on panel **F** into cams on panels **Y1** and **Y2**.

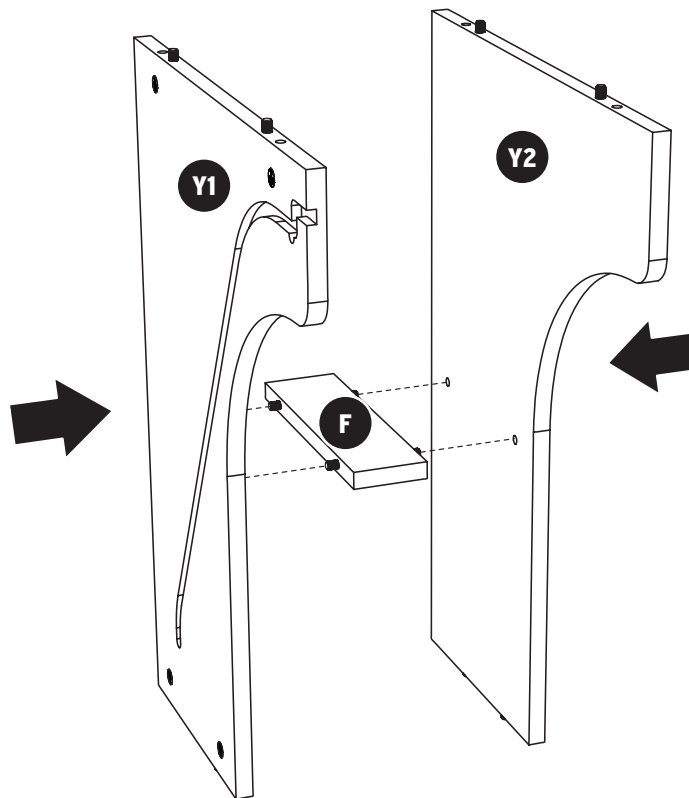

**c2**



5/8" Cam Cover **x4**

### Step 11. Panels Y1, Y2 and F assembly.

1. Lower Unit **Y1-F-Y2** over cam bolts **c1** on panel **G** tighten in a clockwise direction as illustrated below.
2. Apply cam covers **c2** over tightened cams.

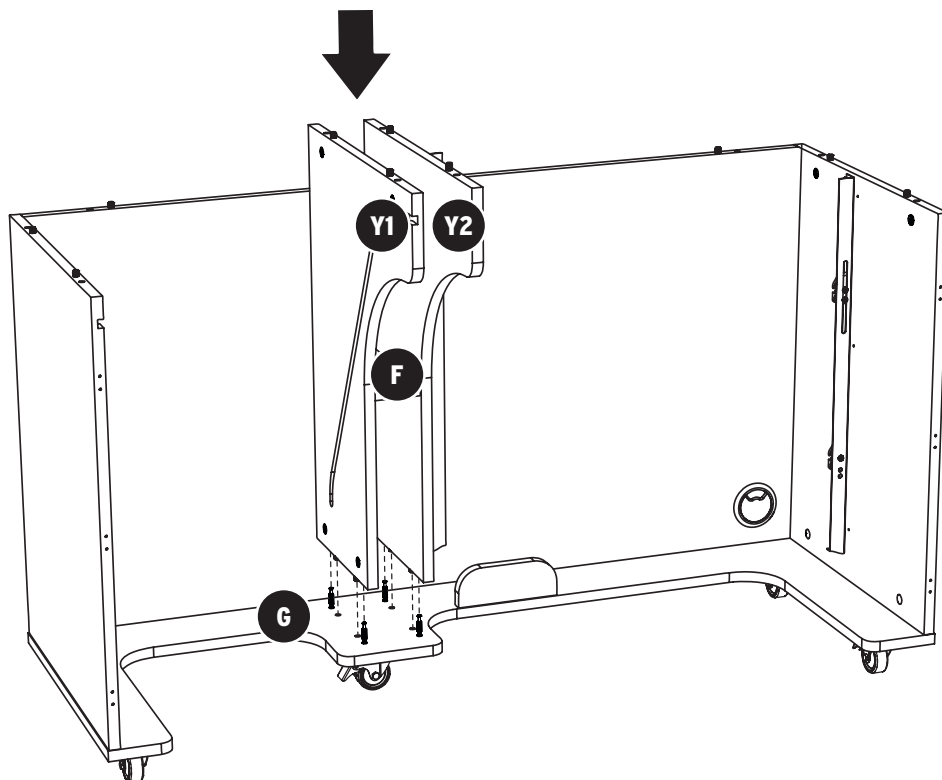

**s1**



3.5x14 Screw **x4**



Lifter **x1**

### Step 12. Lifter Panel assembly.

Fix lifter to panel **A4** using screws **s1** following predrilled holes as shown on the illustration below.

**Note:** Remove cable ties (do not remove wooden block).

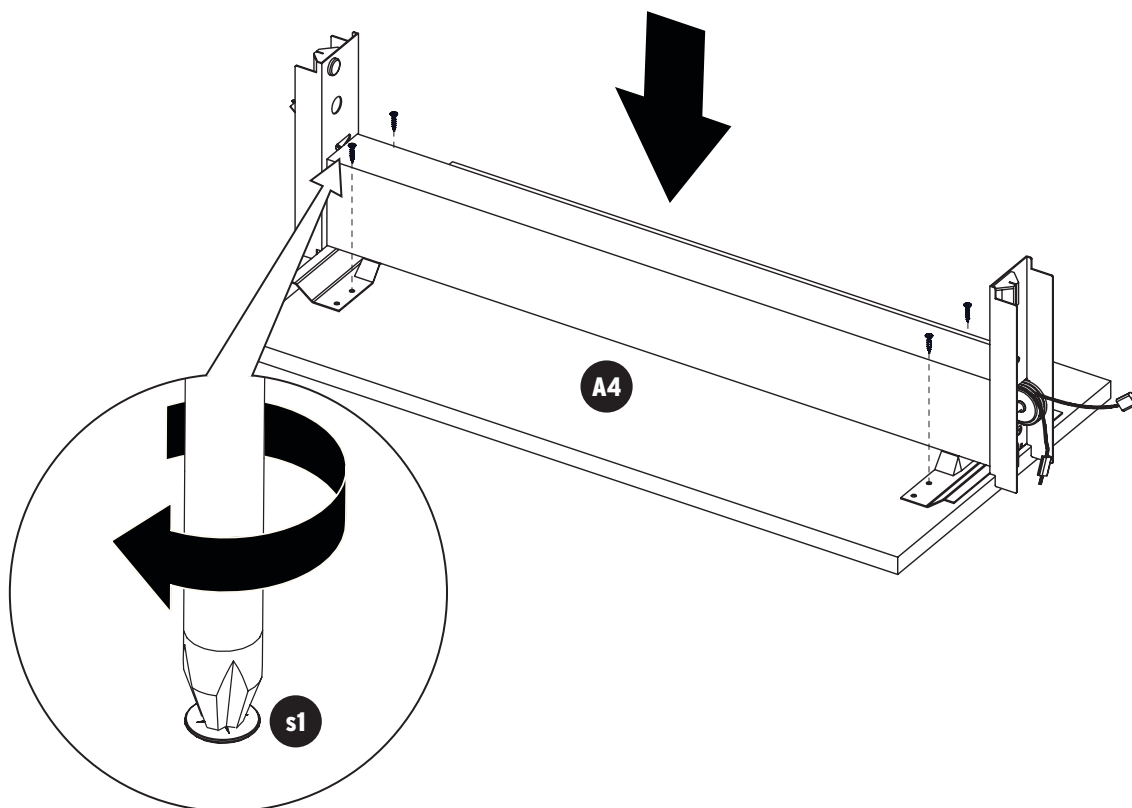

### Step 13. Mounting the Lifter Assembly.

1. Position lifter onto side rails using plastic guides; make sure the cable is hooked into the rail tabs on both sides then lower the lift. See illustration below.
2. When lifter is pushed to first lock position remove a small wooden block that will be released from lifter.

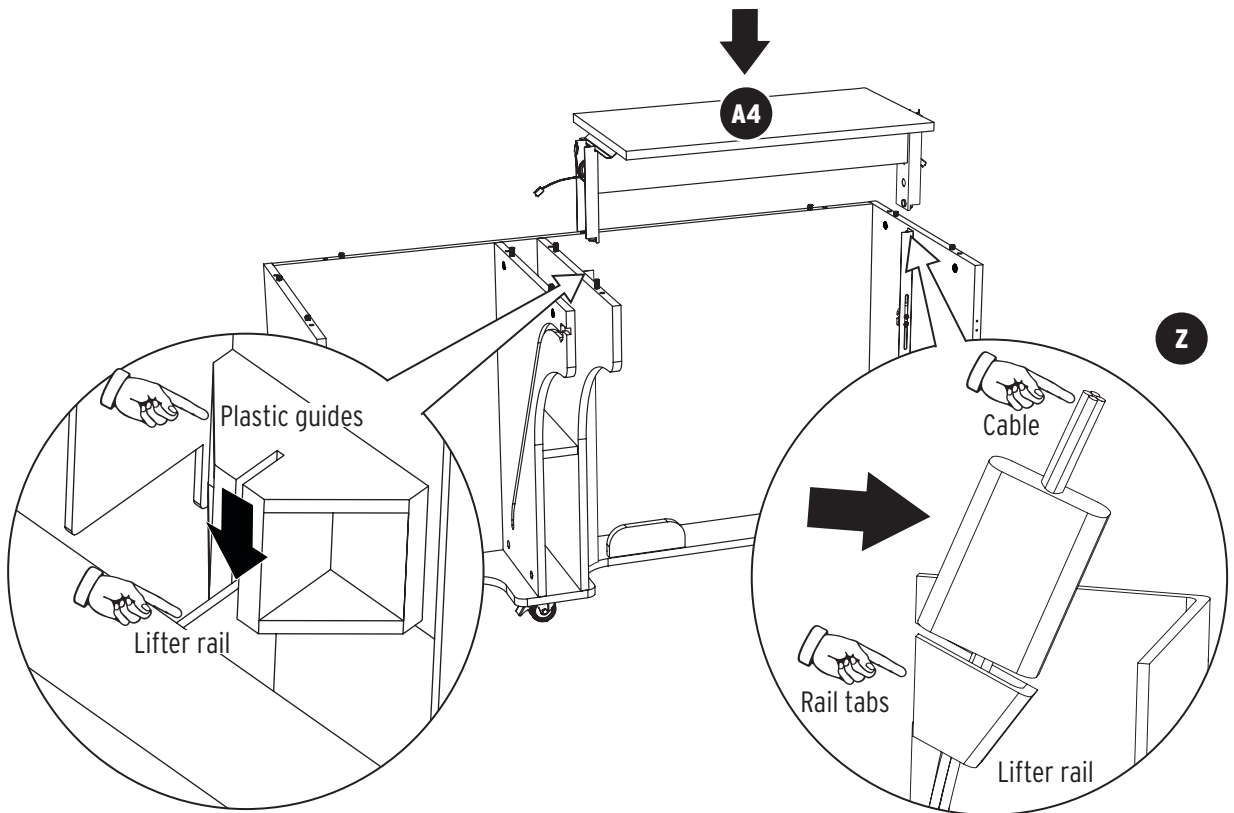

### Step 14. Panel A assembly.

1. Insert cam bolts **c1** on panel **A** into cams on panels **X**, **D**, **Y1**, **Y2** and **Z** and tighten in a clockwise direction as illustrated. Apply cam covers **c2** over tightened cams.

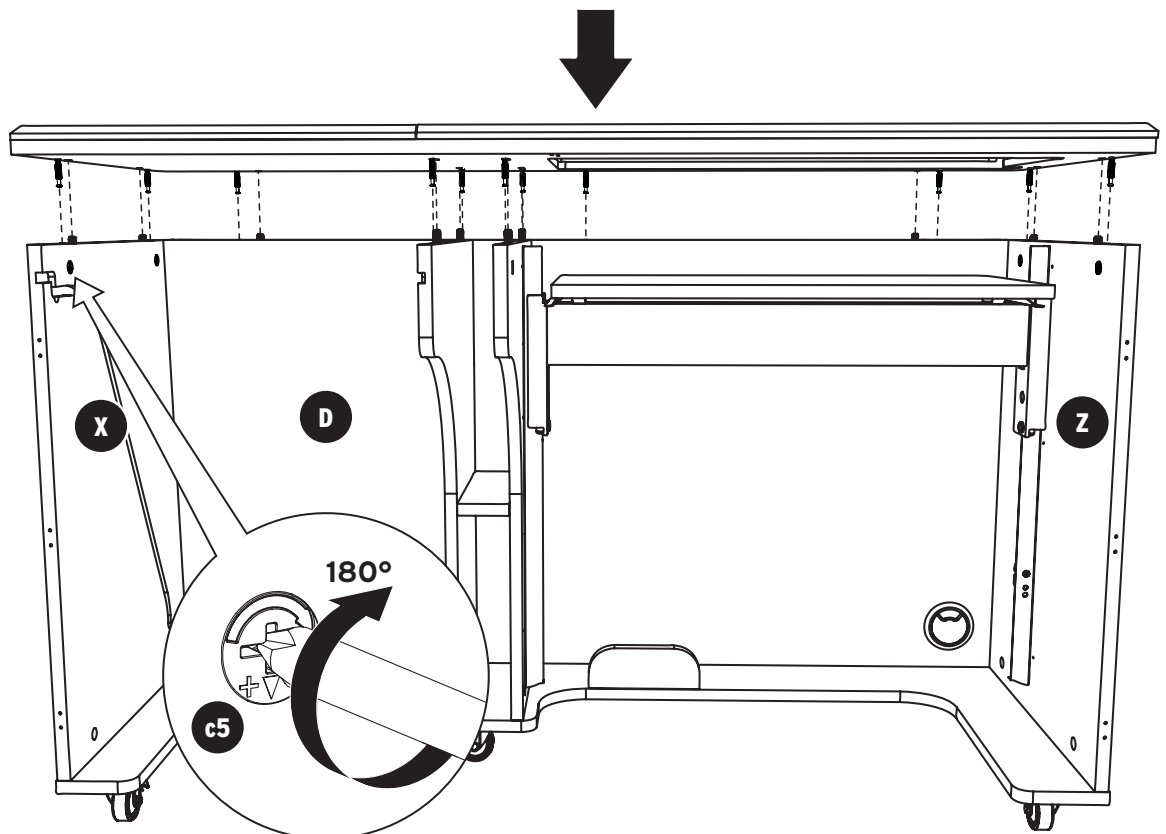

**c2** $\frac{5}{8}$ " Cam Cover **x4****Step 15. Panels L1, L2, K1 and K2 assembly.**

1. Insert cam bolts **c3** on panel **L1** and **K1** into cams on panels **L2** and **K2** and tighten in a clockwise direction as illustrated below. The cams on **K2** and **L2** should face down, not to the inside of the bin.
2. Apply cam covers **c2** over tightened cams.

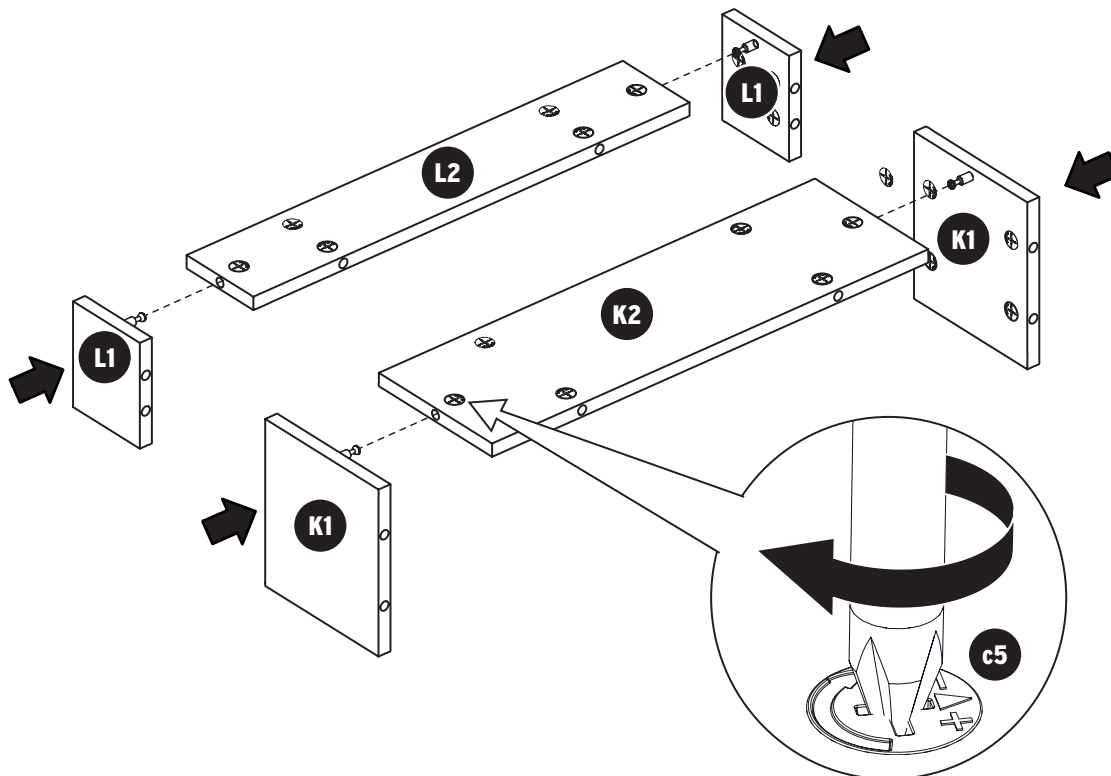
**c2** $\frac{5}{8}$ " Cam Cover **x12****Step 16. Panels K and L assembly.**

1. Insert cam bolts **c3** on panel **K** into cams on panels **K1** and **K2** and tighten in a clockwise direction as illustrated below.
2. Insert cam bolts **c3** on panel **L** into cams on panels **L1** and **L2** and tighten in a clockwise direction as illustrated below.
3. Apply cam covers **c2** over tightened cams.

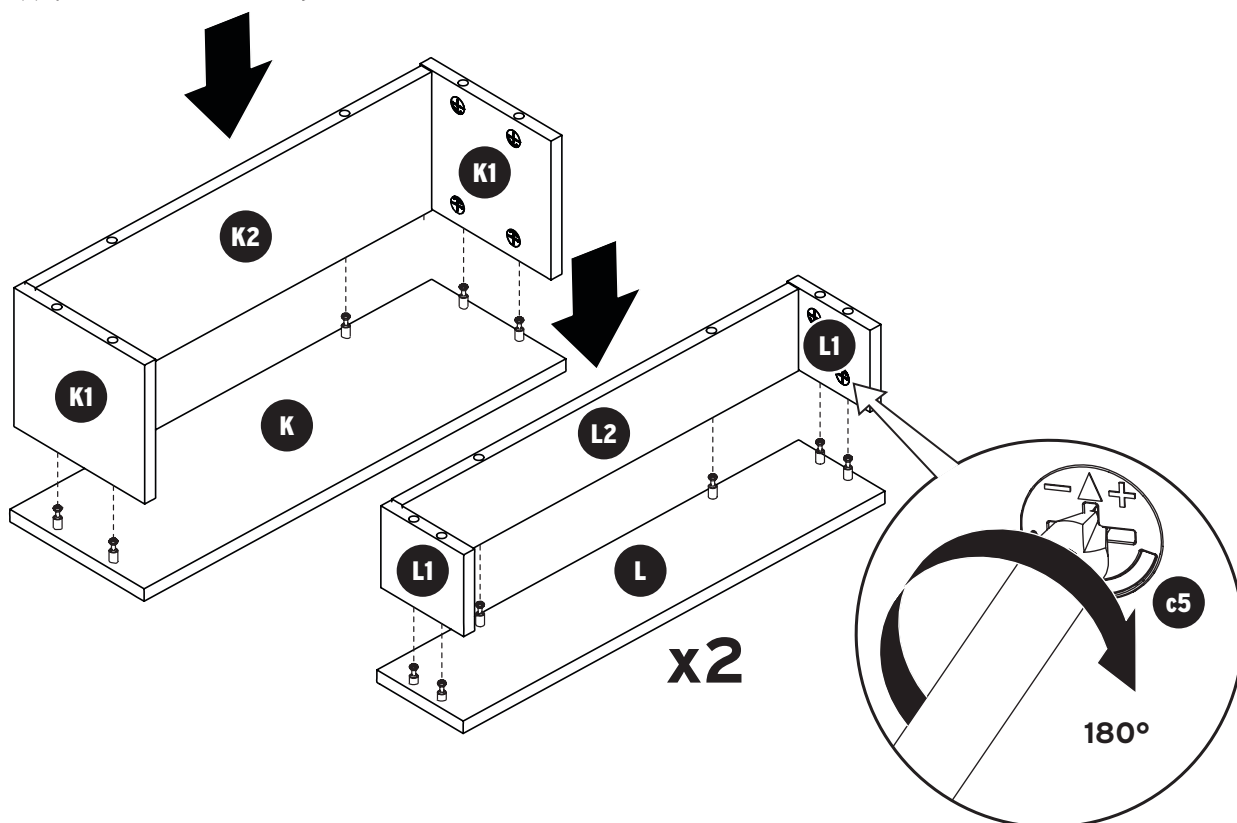

**c2**5/8" Cam Cover **x18****Step 17. Panels V2, K and L assembly.**

1. Insert cam bolts **c3** on panel **V2** into cams found on **L1** and **L2** assembled in Step 15 and **K1** and **K2** assembled in Step 16.
2. Tighten cams in clockwise direction attaching bins to Door **V2**.  
Apply cam covers **c2** over tightened cams.

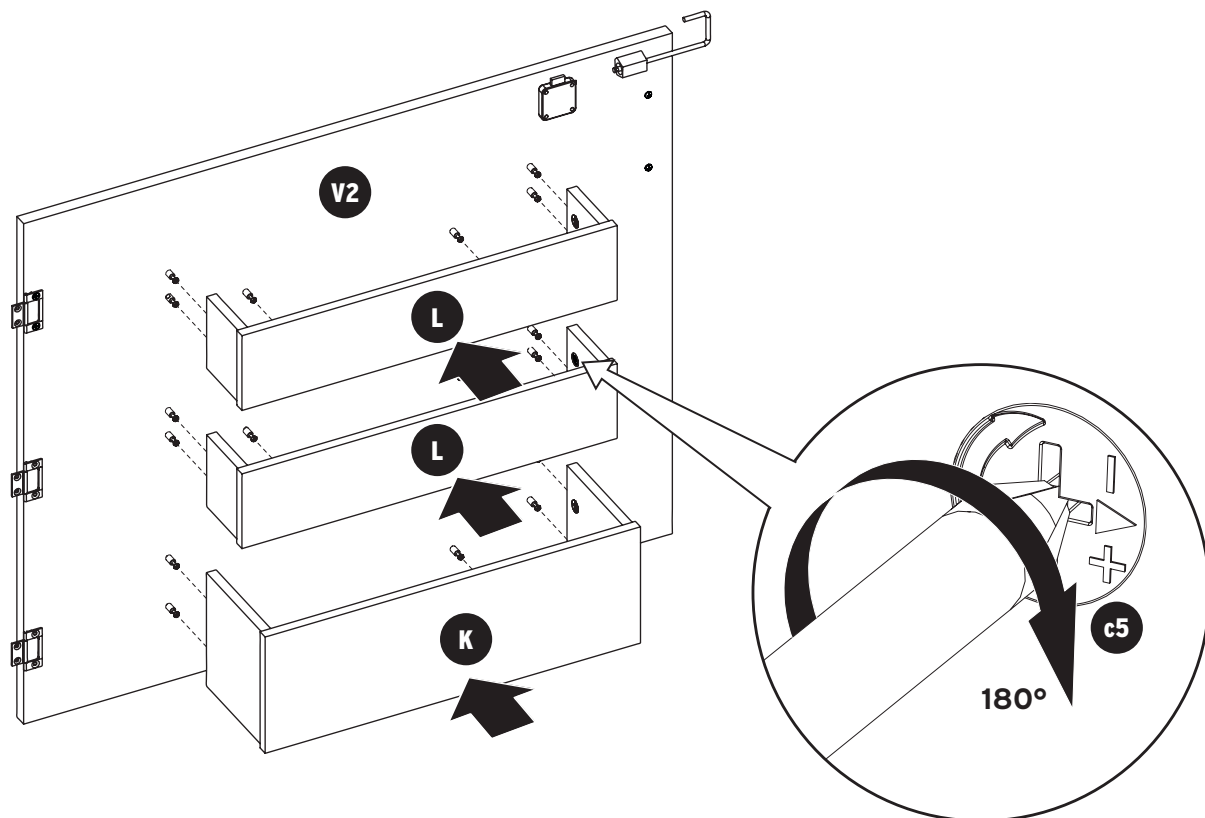
**s2**3x14 Screw **x12****Step 18. Panels V1 and V2 assembly.**

1. Add door **V1** to side panel **X** attaching flush hinges **h2** using screws **s2**.
2. Add door **V2** to side panel **Z** attaching flush hinges **h2** using screws **s2**. It is helpful to have two people hold the door, but it is not required.

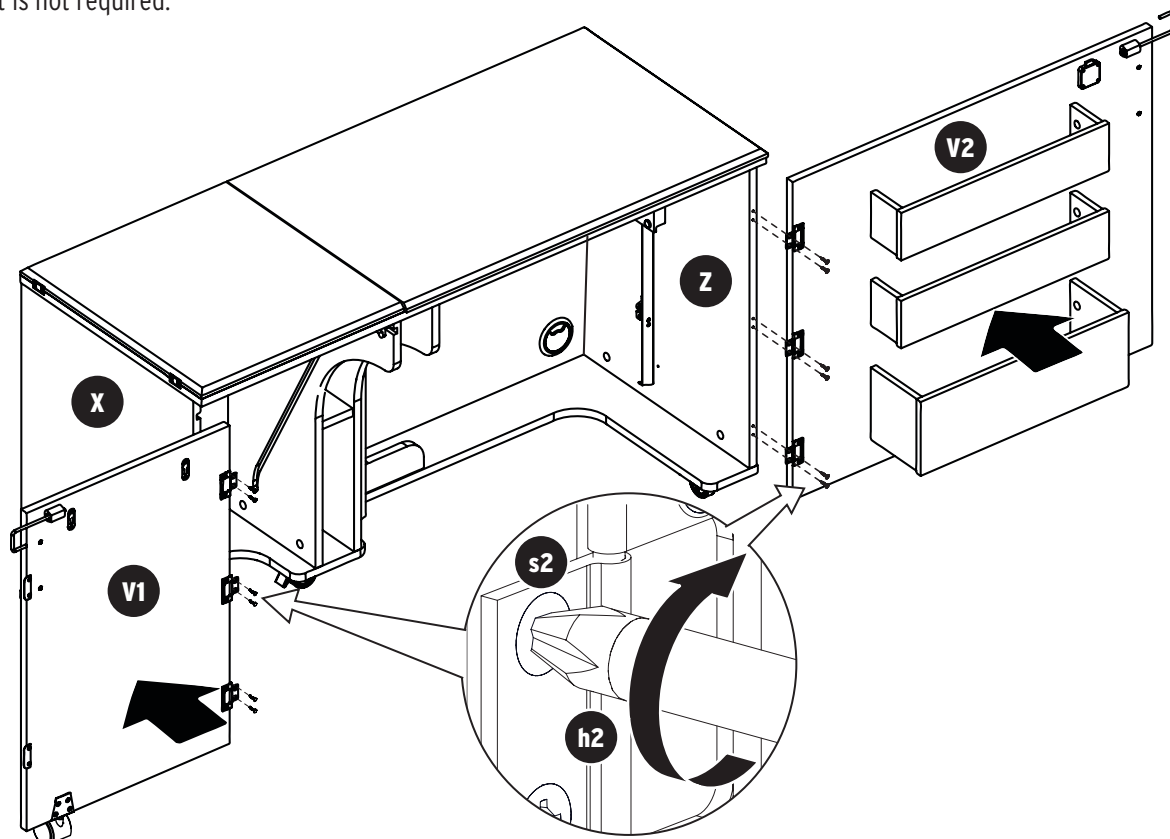

**s1**   
3.5x14 Screw **x6**

### Step 19. Panel 01 assembly.

Fix panel **01** butt hinges **h1** onto panel **D** using screws **s1** as illustrated below.

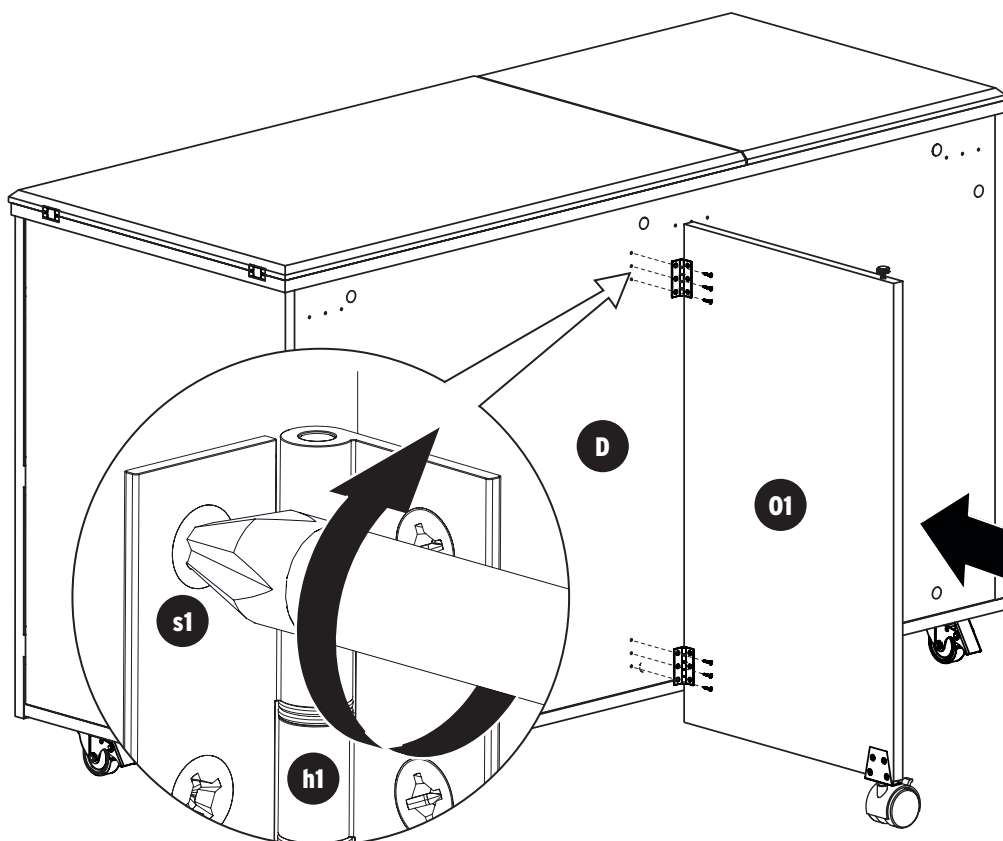

**s1**   
3.5x14 Screw **x9**

### Step 20. Panel A1 assembly.

1. Have a second person hold the **A1** Quilt panel balanced on the gate leg panel **01**.
2. Using screws **s1** attach the flap hinges **h3** to panels **D** and **A1** from underneath panel **A1**.

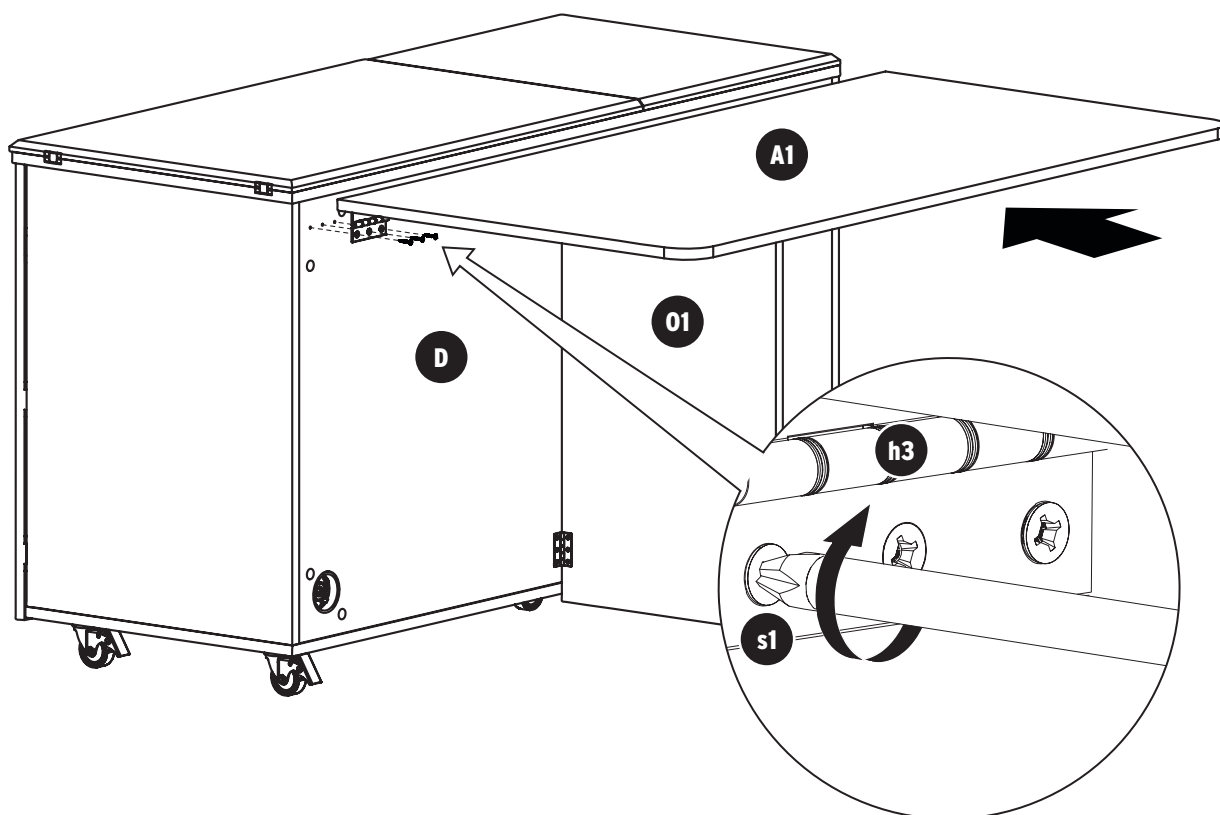



# CADDY Parts List

ITEM	DESCRIPTION	QTY.	PACK.
<b>A</b>	Top Panel	1	4 of 4
<b>A1</b>	Top Panel Leaf	1	4 of 4
<b>G</b>	Bottom Panel	1	4 of 4
<b>D</b>	Back Panel	1	4 of 4
<b>X</b>	Left Side Panel	1	4 of 4
<b>Z</b>	Right Side Panel	1	4 of 4
<b>L</b>	Drawer Front	2	4 of 4
<b>L1</b>	Drawer Side- Left	2	4 of 4
<b>L2</b>	Drawer Side- Right	2	4 of 4
<b>L3</b>	Drawer Back	2	4 of 4
<b>L4</b>	Drawer Bottom	2	4 of 4
	Hardware Box - PACK.	1	4 of 4

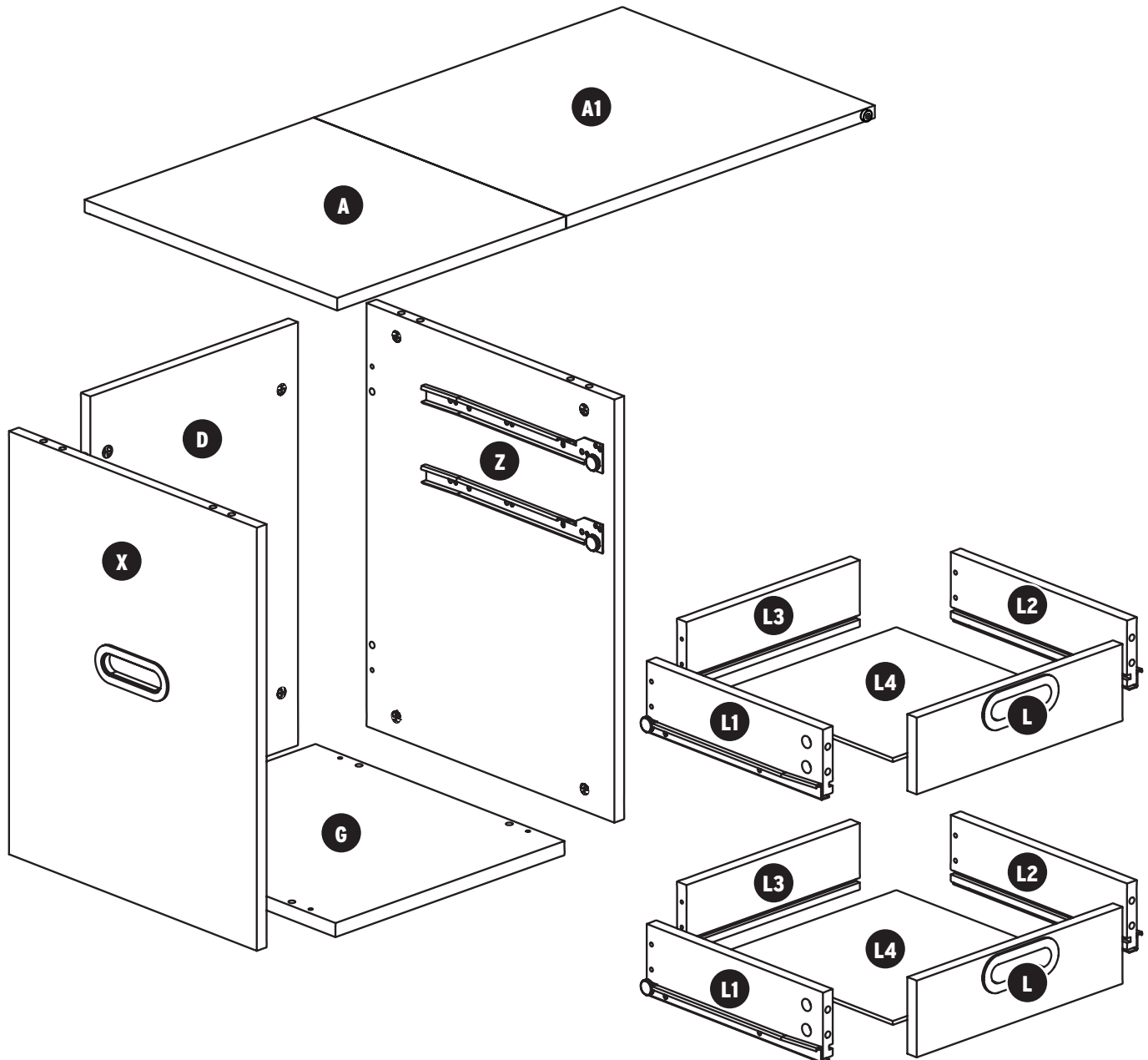

# Parts List

ITEM	DESCRIPTION	QTY.
<b>c1</b>	6x35 Cam Bolt	20
<b>c2</b>	5/8" Cam Cover	20
<b>d1</b>	8x30 Dowel Pin	12
<b>t3</b>	Caster	4
<b>b4</b>	Caster Washer	4
<b>s3</b>	3.5x35 Screw	8
<b>h1</b>	Butt hinge (Pre-installed)	2



**c1** 6x35 Cam Bolt **x20**



**c2** 5/8" Cam Cover **x20**

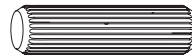

**d1** 8x30 Dowel Pin **x12**



**s3** 3.5x35 Screw **x8**

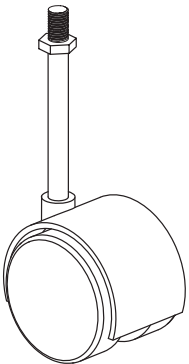

**t3** Caster **x4**

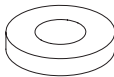

**b4** Caster Washer **x4**

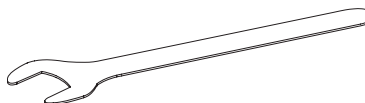

**r4** 12mm Spanner **x1**

## Pre-installed parts



Cam

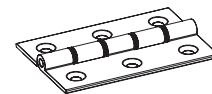

Butt Hinge

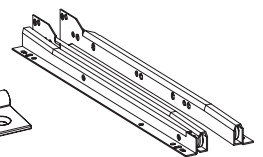

Drawer Runners

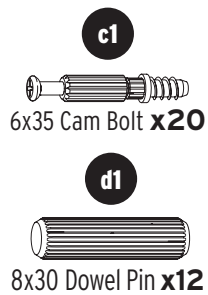

### Step 21. Preparation Panels X, Z, D, A, L.

1. Insert cam bolt **c1** into panels **A**, **G**, **L**, **X** and **Z** as illustrated below.
2. Insert dowel pins **d1** to panels **X**, **D** and **Z** as illustrated below.

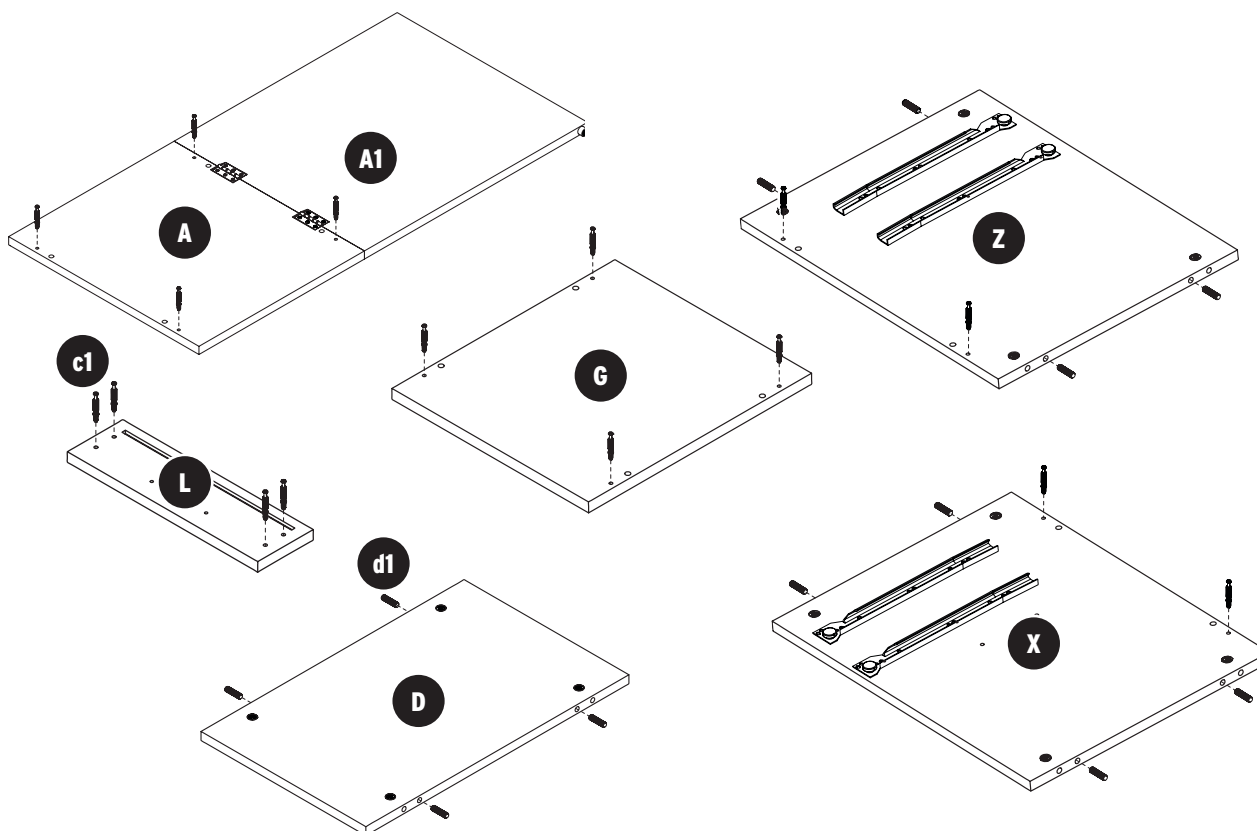

### Step 22. Panels X, Z and D assembly.

1. Insert cam bolts **c1** on panel **X** and **Z** into cams on panel **D** and tighten in clockwise direction as shown.

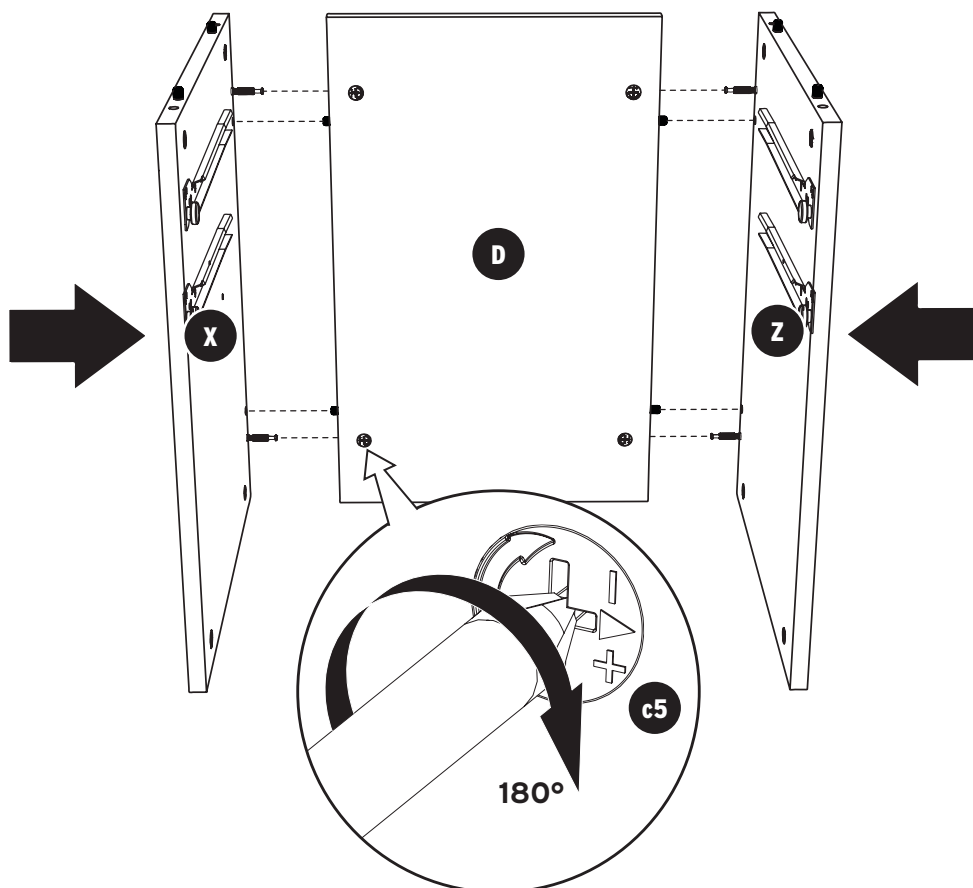

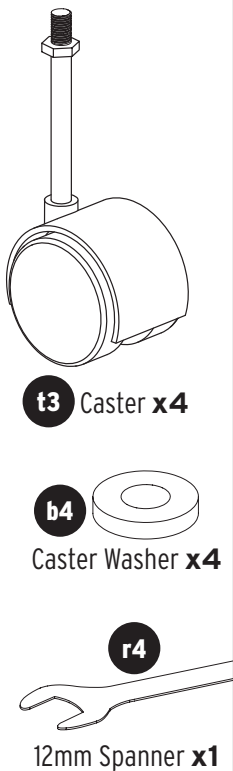

### Step 23. Panel G assembly

1. Place caster washer **b4** on extension casters **t3** and screw into anchors in bottom panel **G**.

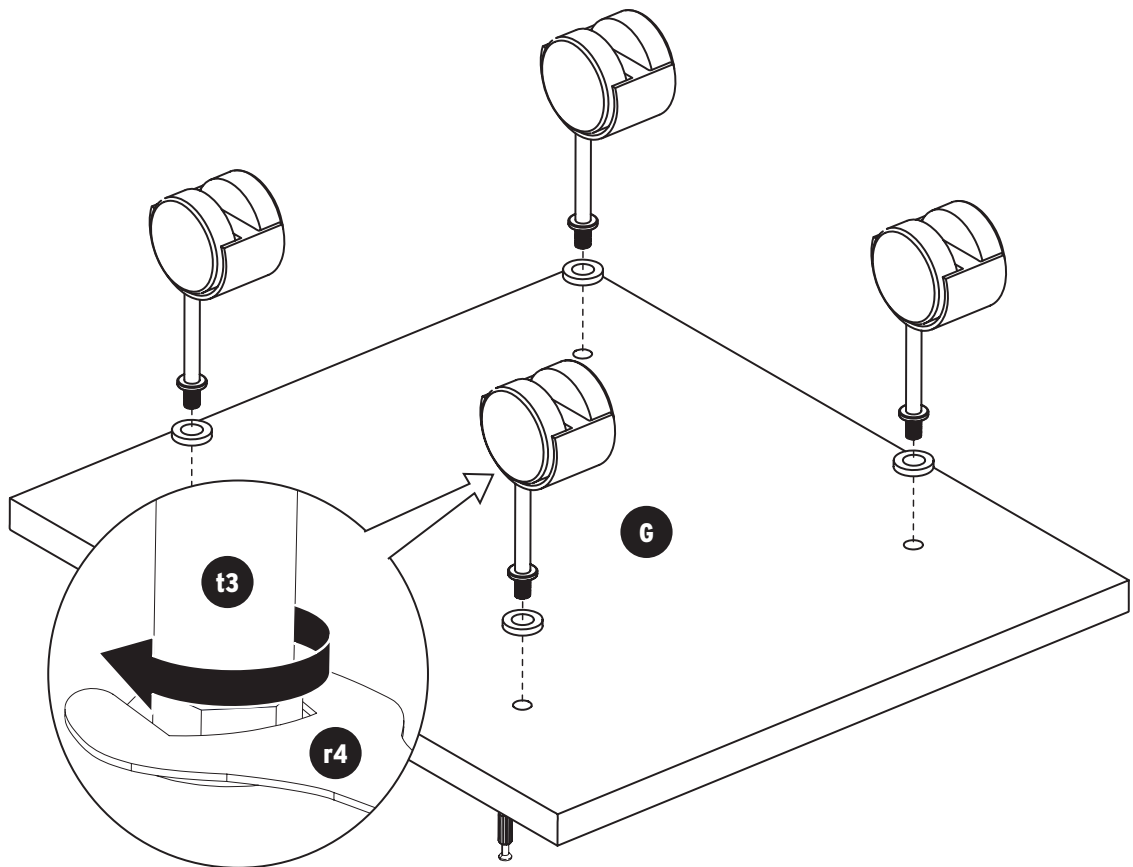

### Step 24. Panel A and G assembly.

1. Insert cam bolts **c1** on bottom panel **G** into cams in panels **X** and **Z**. Tighten cams in clockwise direction.
2. Insert cam bolts **c1** on panel **A** into cams on panels **X**, **D** and **Z** and tightened in a clockwise direction.

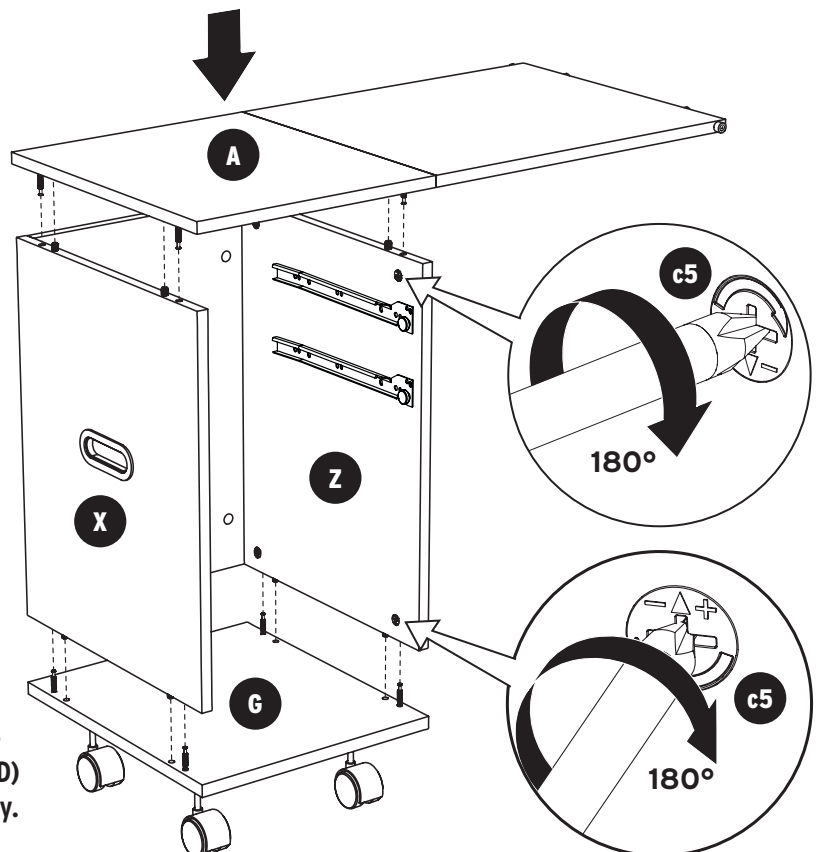

Locate the arrow sticker on bottom panel **G**.  
The arrow sticker should face the back of the caddy (panel **D**) to orient the bottom correctly.

**s3**

 3.5x35 Screw **x8**
**c2**

 5/8" Cam Cover **x8**
**Step 24. Drawer assembly.**

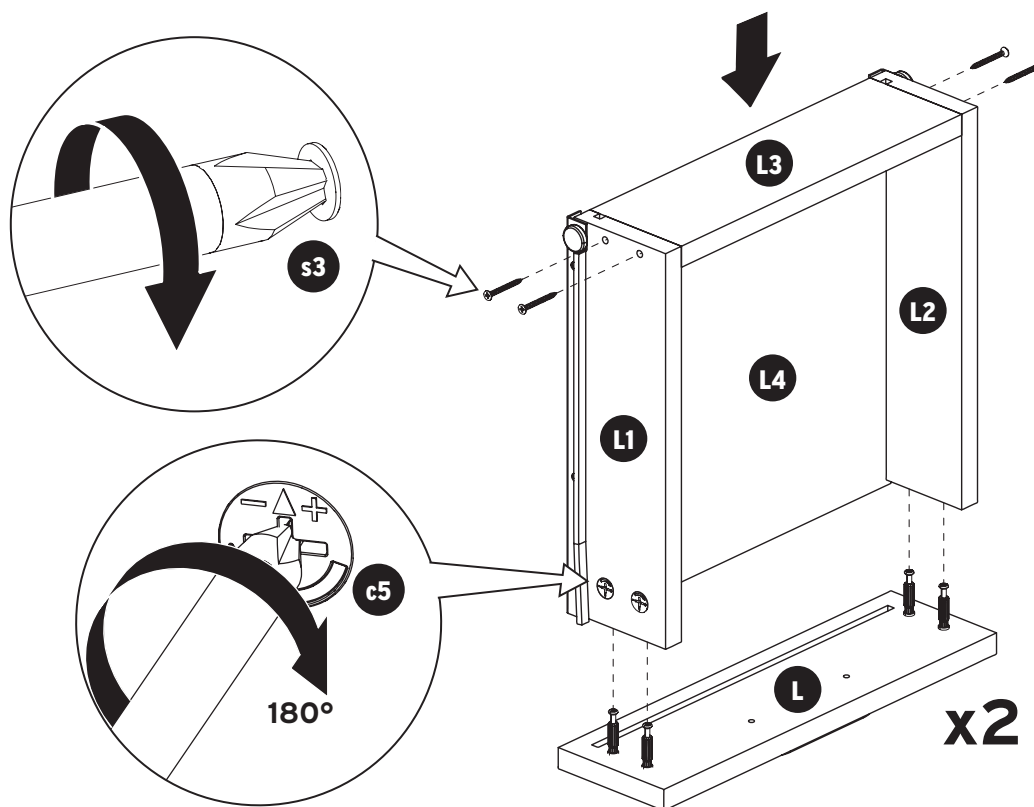
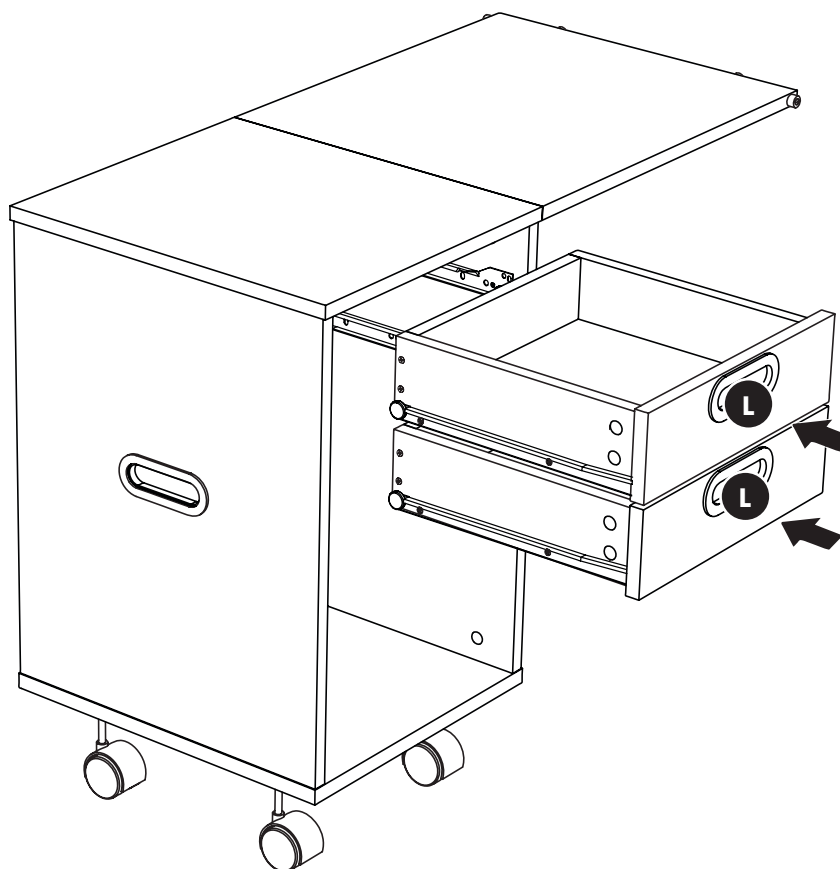
1. Slide bottom **L4** into **L**, **L1**, **L2** and **L3** grooves as illustrated.
2. Connect drawer panels **L1**, **L2** and **L3** with screws **s3** as illustrated below.
3. Insert cam bolts **c3** on panel **L** into cams on panels **L1** and **L2** and tighten in a clockwise direction as illustrated below.

**Step 25. Slide drawer into caddy, aligning drawer runners.**

### Step 26. Caddy positioning

1. Position the caddy in front of the cabinet and carefully lift the flap. Place the pre-installed flap rollers into the groove and gently slide the caddy into the cabinets.

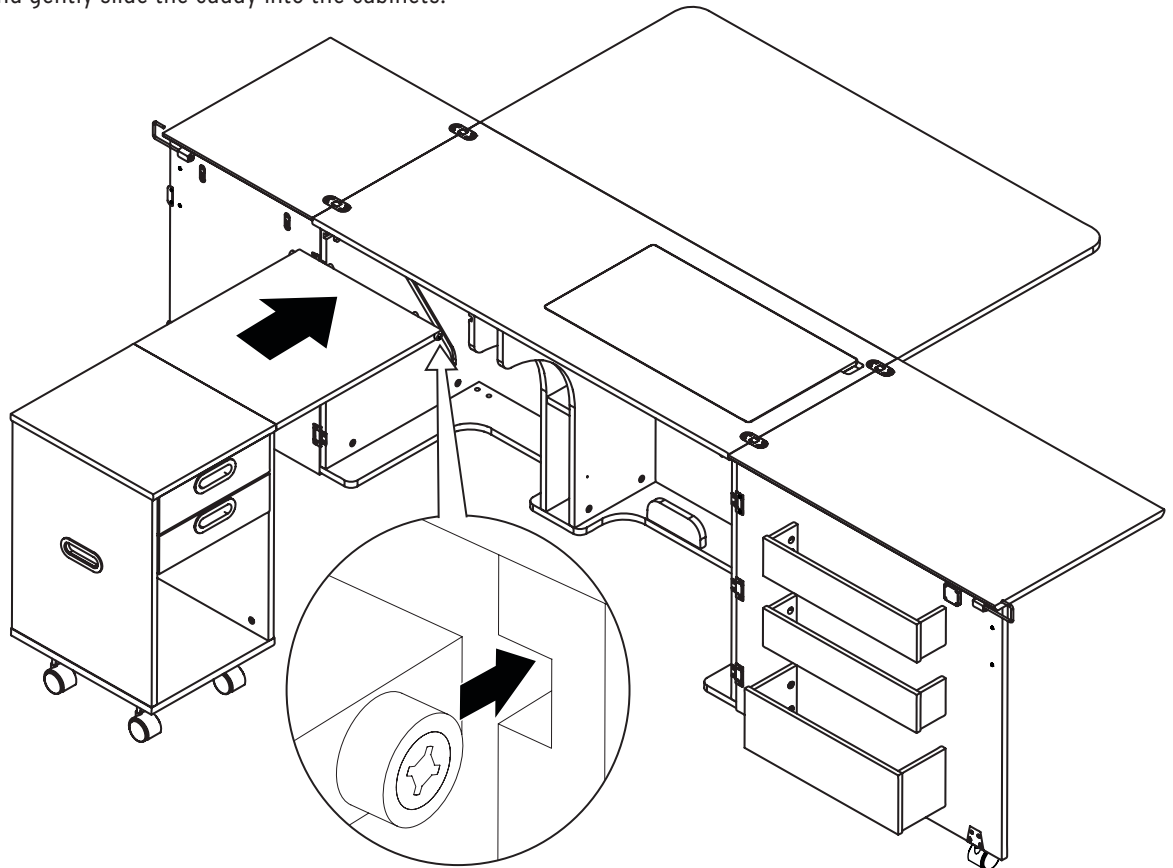

### Step 27. Caddy positioning

1. Make sure the door is open and secured to cabinet leaf with Door Hook and caster is locked.
2. Position the Caddy in front of door and lift the flap.
3. Place the heads of 2 screws pre-installed in Caddy flap into the Panel Connectors and press into place to secure.
4. Lift end of flap to detach the screws from panel connectors to disengage.

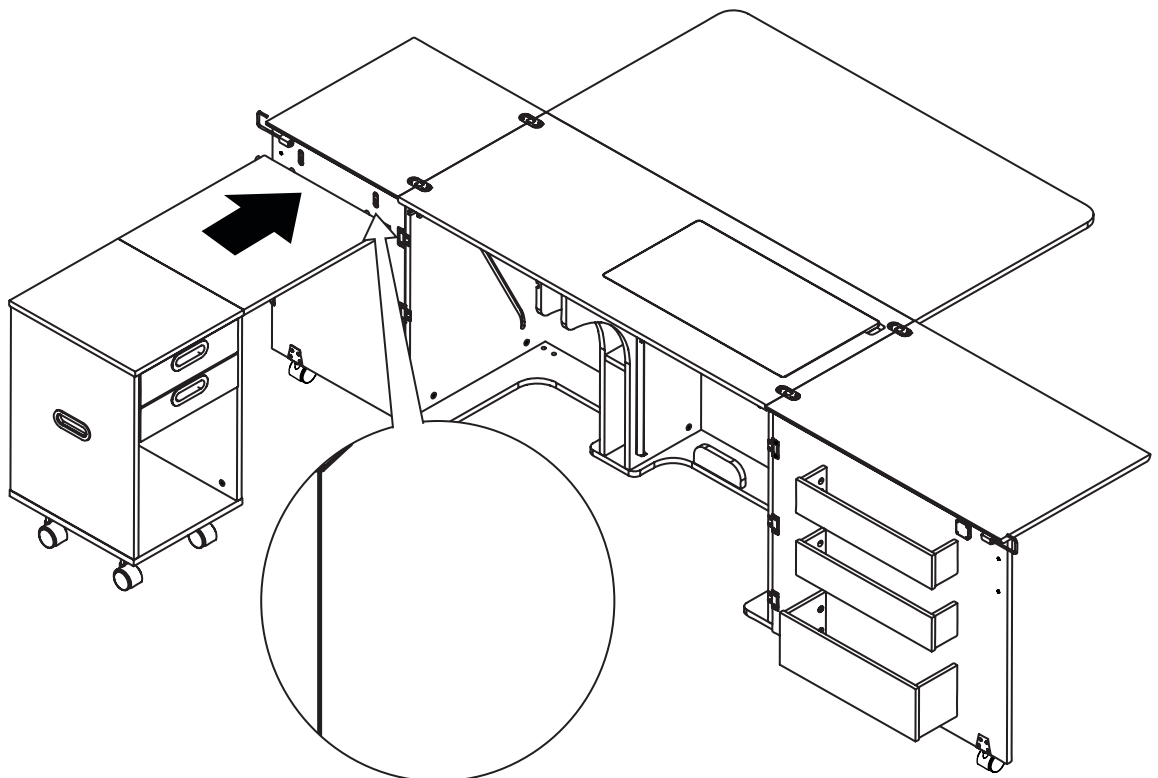

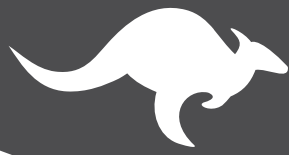

KANGAROO™  
sewing furniture

## LIMITED LIFETIME WARRANTY

### Kangaroo™ Sewing Furniture Limited Lifetime Warranty

**WHAT THIS WARRANTY COVERS:** Arrow Companies, LLC (Arrow) provides a Limited Lifetime Warranty (warranty) to the original purchaser of this product against defects in materials or workmanship of furniture components. As used in this Warranty, "defect" means imperfections in components which substantially impair the utility of the product. This Warranty gives you specific legal rights, and you may also have other rights which vary from state to state. Electrical and mechanical components of furniture are warranted for 5 years.

**HOW TO GET SERVICE:** Simply contact Arrow at 1-800-533-7347 or CS@ArrowCabinets.com. When you request warranty service, you must also present proof of purchase documentation, which includes the date of purchase (detailed receipt), and photos of the product. Arrow will replace any defective part (at its sole option), excluding labor. Replacement parts will be warranted for only the remaining period of the original Warranty.

Replacement parts will be shipped freight prepaid on any initial warranty claim during first year of Warranty only. Warranty applies only to defects confirmed by Arrow Companies, LLC and will be replaced or repaired at Arrow's option. In the event parts are no longer available for a warranty claim, customer may receive brand new cabinet at a price equal to 60% off the MSRP of a current comparable model.

**WHAT'S NOT COVERED:** There is no warranty coverage for defects or conditions that result from the failure to follow product assembly instructions, information or warnings, misuse or abuse, intentional damage, fire, flood, alteration or modification of the product, or use of the product in a manner inconsistent with its intended use, nor any condition resulting from incorrect or inadequate maintenance, cleaning, or care, or neglect, cuts or scratches. Caster damage as a result of moving furniture fully loaded or with locked casters. Damage resulting from electrical surge or lightning. Use in commercial or education environments. Kangaroo Sewing Furniture is designed for residential use only.

ARROW SHALL HAVE NO LIABILITY for ANY INCIDENTAL OR CONSEQUENTIAL DAMAGES OF ANY KIND and all such damages are EXCLUDED FROM THIS WARRANTY, such as loss of use, disassembly, transportation, labor or damage to property on or near the product. Some states do not allow the exclusion or limitation of incidental or consequential damages, so the above limitation or exclusion may not apply to you. The Warranty cannot be transferred to subsequent owners or users of the product, and it shall be immediately void in the event the product is resold, transferred, leased or rented to any third party or person other than the original purchaser.

#### ADDITIONAL LIMITATIONS:

THERE ARE NO OTHER WARRANTIES APPLICABLE TO THIS PRODUCT. Under the laws of certain states, there may be no implied warranties from Arrow and all implied warranties, INCLUDING ANY IMPLIED WARRANTY OF MERCHANTABILITY OR FITNESS FOR A PARTICULAR PURPOSE are disclaimed where allowed by law. TO THE EXTENT ANY IMPLIED WARRANTIES ARE APPLICABLE, ANY IMPLIED WARRANTIES, INCLUDING ANY IMPLIED WARRANTY OF MERCHANTABILITY OR FITNESS FOR A PARTICULAR PURPOSE, ARE LIMITED IN DURATION TO THE DURATION OF THIS EXPRESS WARRANTY or the minimum period allowed by law, whichever is shorter. Some states do not allow limitations on how long an implied Warranty lasts, so the above limitation may not apply to you. This limited warranty gives you specific legal rights. This limited warranty does not, in any way, affect the rights given to you by law.

**REGISTER YOUR PRODUCT:** Original purchaser should register the purchase online at [www.ArrowCabinets.com/warranty](http://www.ArrowCabinets.com/warranty).

SEW IN COMFORT. SEW LONGER.™



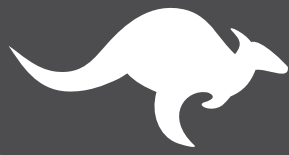

# KANGAROO™

sewing furniture

## Accessories to Complete Your Sewing Experience

### Custom Insert

Enhance your sewing experience with a custom-made insert for your Arrow or Kangaroo cabinet. Inserts are designed to reduce the gap between the machine and cabinet opening. This provides an ergonomic work surface for the free arm of the sewing machine, allowing for straighter stitches, less fatigue and an overall better experience using your machine and cabinet.

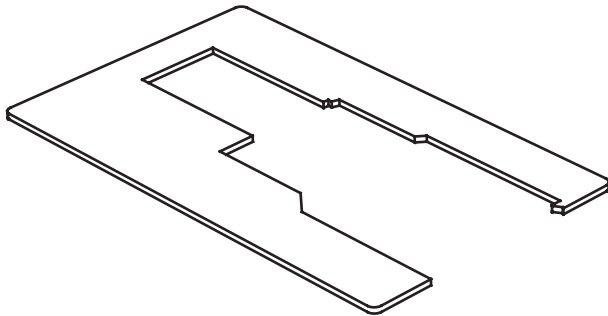

Insert

### Arrow Sewing Chairs

Our adjustable height sewing chair is a perfect accessory for any craft and sewing room. The chair's height is adjustable with easy to use controls and the cushions provide perfect lumbar support and comfort for those long sewing hours. Chair features five casters on a star base for greater movement at your sewing cabinet or crafting surface. Lift the seat cushion to reveal a hidden storage compartment for your small notions or patterns.

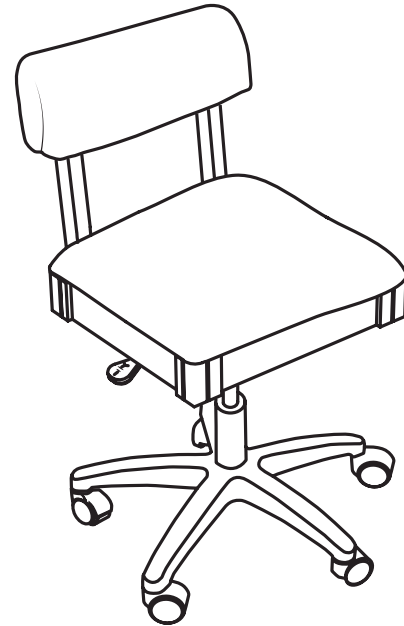

Hydraulic Sewing Chair

P.O. Box 307 Delavan, WI 53115  
1-800-533-7347 Ext. 1  
CS@ArrowCabinets.com  
www.ArrowCabinets.com

05-20