

Top of the cabinet

NOTE: THIS TEMPLATE IS COMPRISED OF TWO PIECES OF 8 1/2 X 11 INCH PAPER.

Align arrows on Page 1 with arrows on Page 2 and tape together to create the full-sized template.

Electric Lift Installation Template

MOD ELECTRIC

Position the template inside the cabinet as shown.

The top edge of the template paper should touch the top panel of the cabinet, and the front edge of the template paper should be even with the front edge of the right-hand side panel.

Tape the template in place to prevent it from shifting as you drill.

You will need a 1/16" Drill Bit.

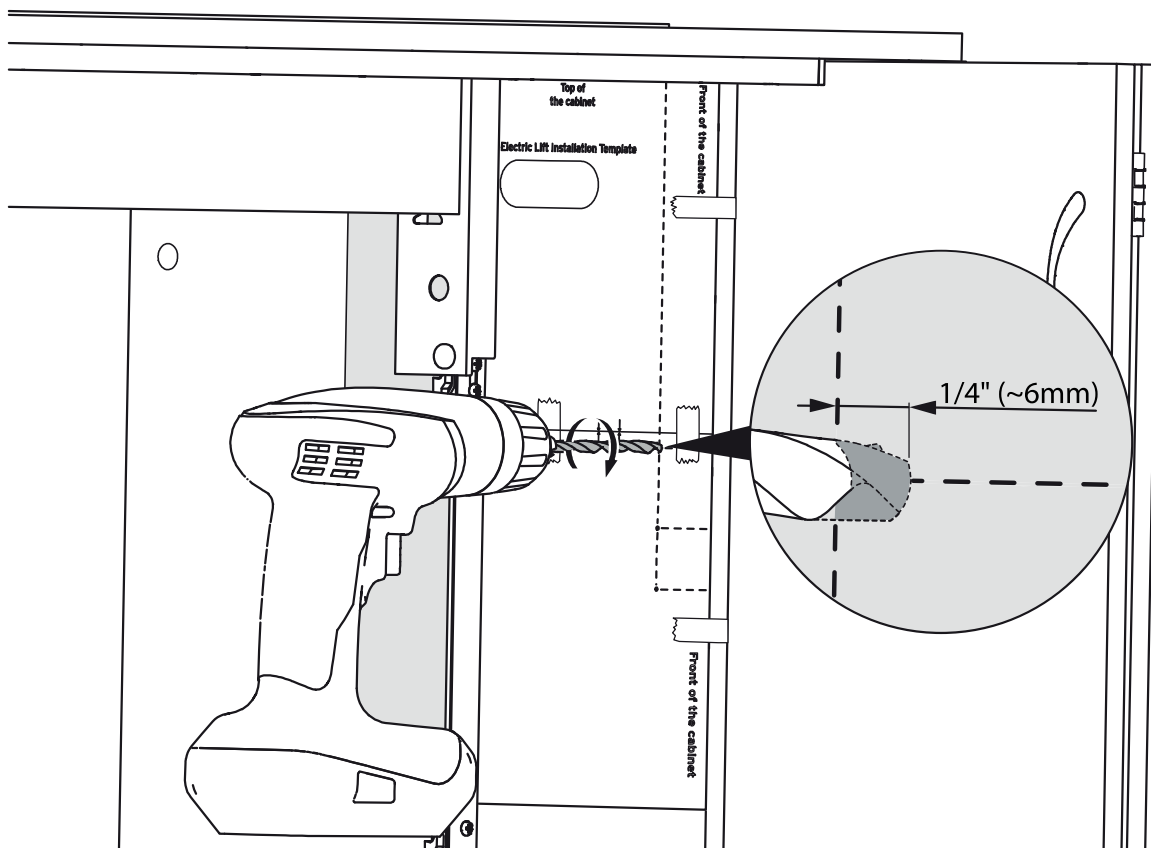

Front of the cabinet

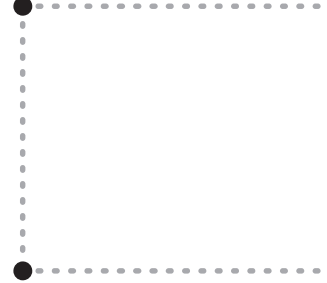

Front of the cabinet

Make sure your printer output is set to Actual Size or 100%.
Doublecheck your printed template against your controller.
If all 3 of the holes do not line up with the 3 drilling markers,
call Customer Service for assistance at 1-800-533-7347, ext. 1

Drill pilot holes NO DEEPER THAN 1/4" into the panel.
DO NOT DRILL ALL THE WAY THROUGH THE PANEL!

Once your pilot holes are drilled, remove the template paper and use
the provided screws (3) to mount the Vertical Programmable Controller.